

Model Path = C:\Users\Tatsuya\GoogleDrive\OUXT\InventorProjects\MRX14\RearProp_1st\PropulsionBaseUnit.iam
 Drawing Path = C:\Users\Tatsuya\GoogleDrive\OUXT\InventorProjects\MRX14\RearProp_1st\Drawing\RearProp.idw

部品表		
項目	部品番号	数量
1	ClumpBlock	1
2	RubberSheet1	1
3	RubberSheet2	1
4	RubberSheet3	1
5	RubberSheet4	1
6	ClumpPlate	1
7	MountPlate	1
8	ShaftHolder1	4
9	LinkRod	2
10	SC1006A	4
11	JIS B 1176 - M6 x 20	9
12	JIS B 1176 - M6 x 16	16

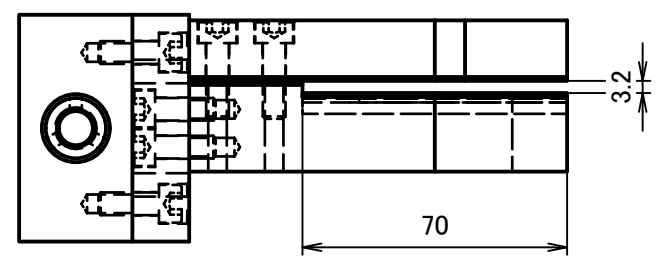
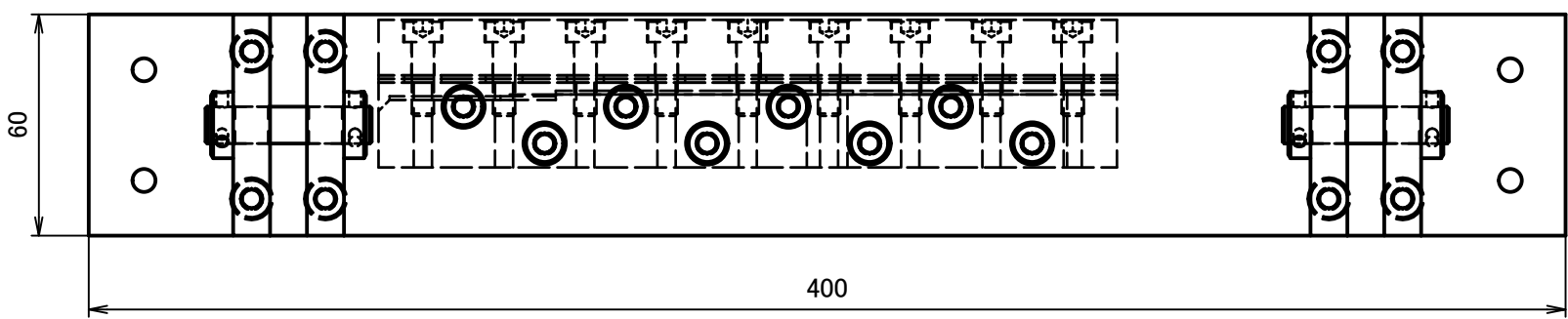
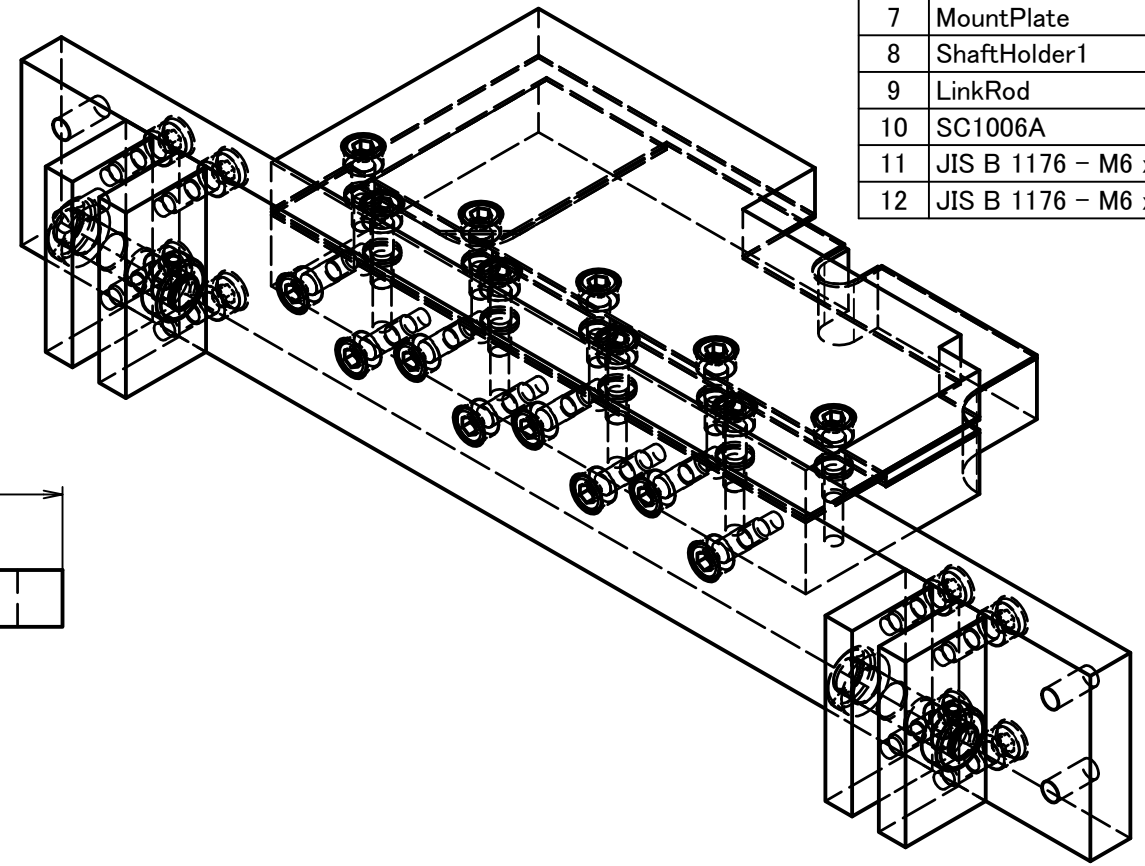
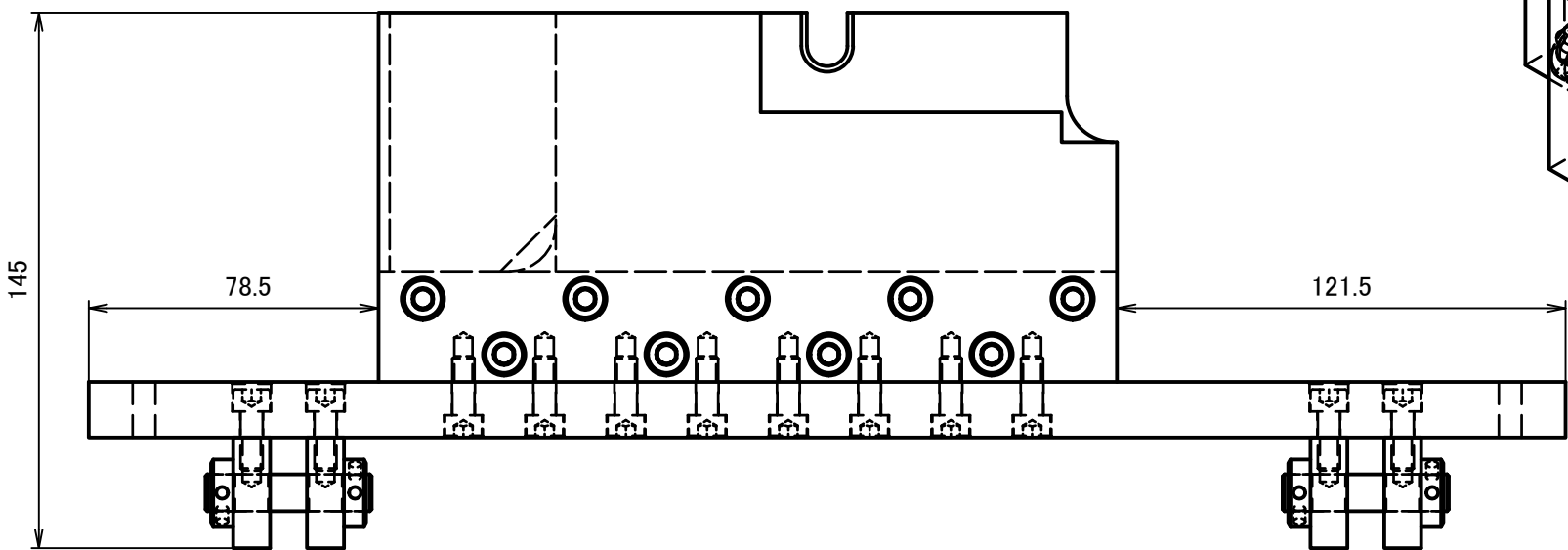

M = 3102.497 g
 V = 1123754.903 mm³
 SA = 291253.564 mm²

	(H)	(B)	(S)	(D)	(L)	(MM)	(MM)SPF550-VD	(NCM)	(MC)	(TPP)	(LPM)	(3DP)	(3DP)DMM service
Division	0.5~3	3~6	6~30	30~120	120~400	400~1000	1000~2000	2000~4000	Note				
f	±0.05	±0.05	±0.1	±0.15	±0.2	±0.3	±0.5						
m	±0.1	±0.1	±0.2	±0.3	±0.5	±0.8	±1.2	±2					
c	±0.2	±0.3	±0.5	±0.8	±1.2	±2	±3	±4					
v		±0.5	±1	±1.5	±2.5	±4	±6	±8					

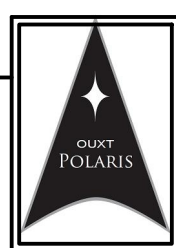

Worker T.sanada	Deadline 2013/12/27	Completion Date 2013/12/27	Qty. 2	Material
Worker's Signature	Total Process Time [min./unit]	Designer's Signature	SheetSize A3	Designer T.sanada
			Pages 1 / 21	Date 2015/03/23
				Rev. 1
				Status リリース
				ProjectName / AssemblyName MaritimeRobotX2014 / RearProp
				PartName PropulsionBaseUnit
				Drawing No. MRX14-RP-A001

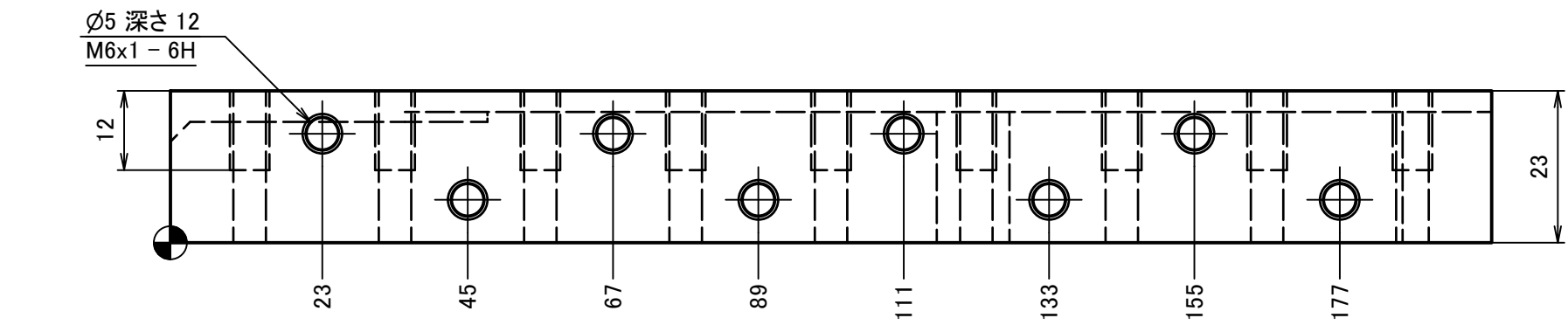
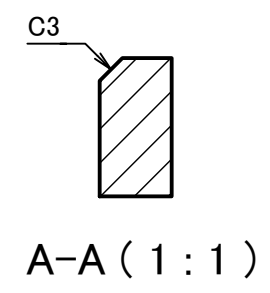
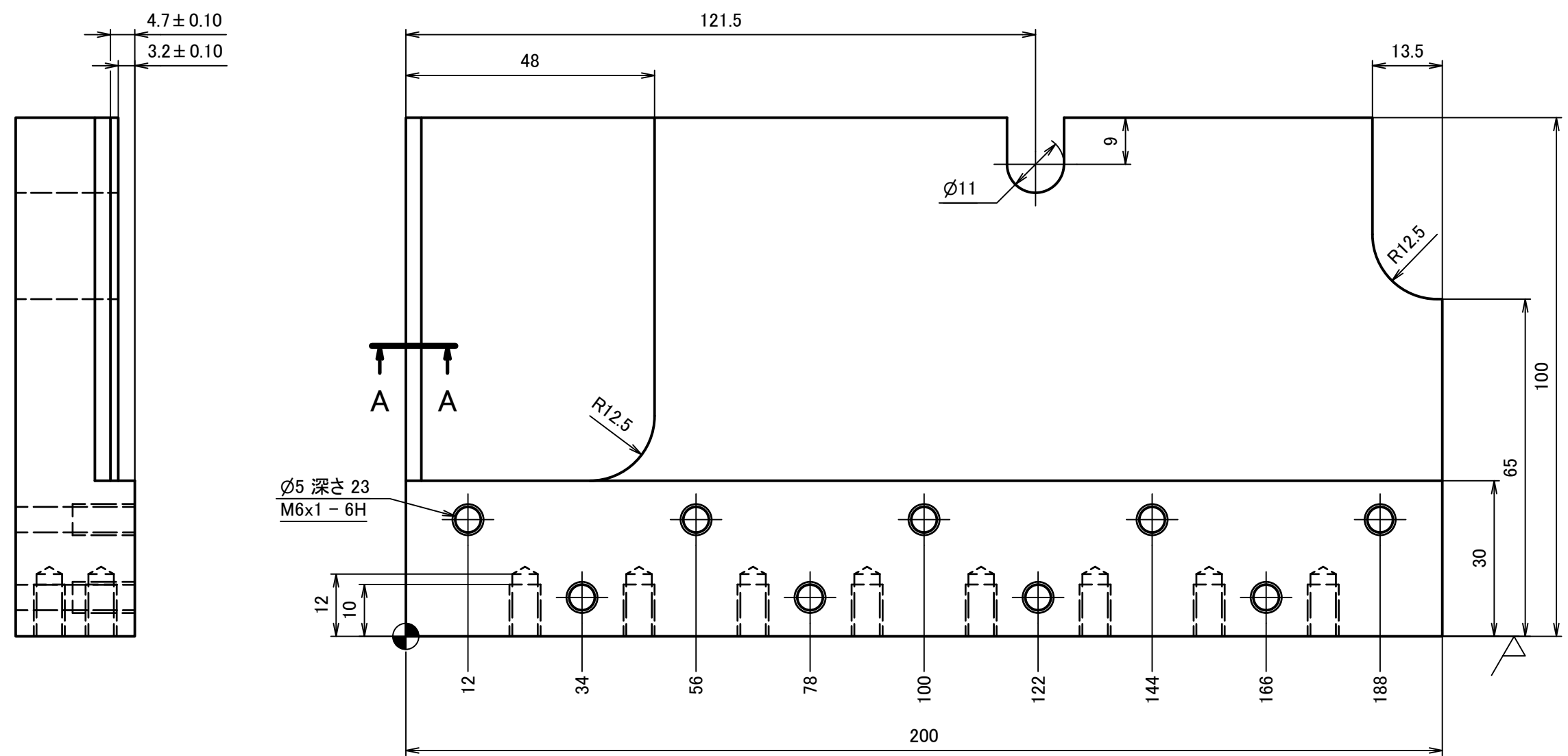

M = 1051.839 g
 V = 392477.309 mm³
 SA = 56786.671 mm²

	(H)	(B)	(S)	(D)	(L)	(MM)	(MM)SPF550-VD	(NCM)	(MC)	(TPP)	(LPM)	(3DP)	(3DP)DMM service
Division	0.5~3	3~6	6~30	30~120	120~400	400~1000	1000~2000	2000~4000	Note				
f	±0.05	±0.05	±0.1	±0.15	±0.2	±0.3	±0.5						
m	±0.1	±0.1	±0.2	±0.3	±0.5	±0.8	±1.2	±2					
c	±0.2	±0.3	±0.5	±0.8	±1.2	±2	±3	±4					
v		±0.5	±1	±1.5	±2.5	±4	±6	±8					

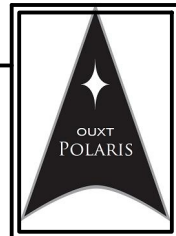

Worker
S.wada
Worker's Signature

Deadline
2013/12/27
Total Process Time
[min./unit]

Completion Date
2013/12/27
Designer's Signature

Qty. **2**
SheetSize A3
Pages 2 / 21

Material アルミニウム 5052			
Designer T.sanada	Date 2013/12/10	Rev. 3	Status リリース
ProjectName / AssemblyName MaritimeRobotX2014 / RearProp			
PartName ClumpBlock			
Drawing No. MRX14-RP-P001			

Model Path = C:\Users\Tatsuya\GoogleDrive\OUXT\InventorProjects\MRX14\RearProp_1st\ClumpPlate.ipt
 Drawing Path = C:\Users\Tatsuya\GoogleDrive\OUXT\InventorProjects\MRX14\RearProp_1st\Drawing\RearProp.idw

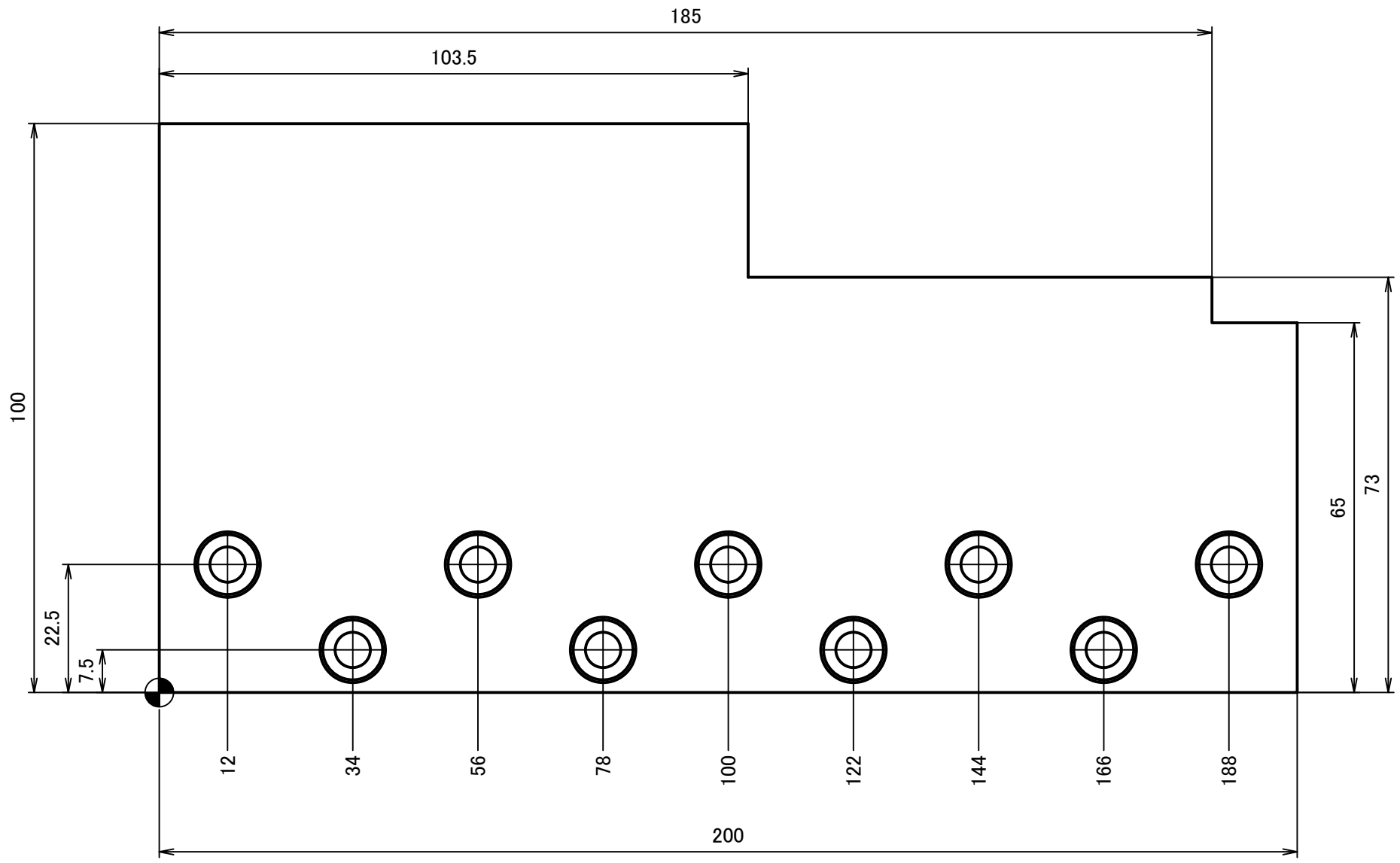

6.2 キリ, 10.5 ざぐりの深さ 6

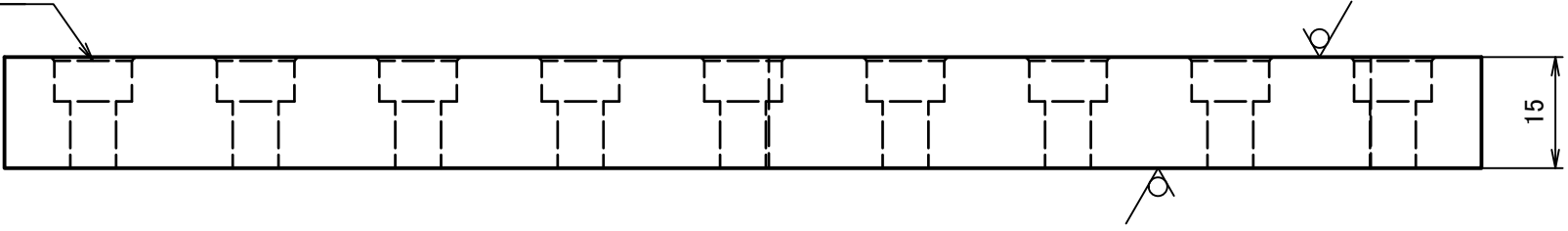

M = 675.247 g
 V = 251957.897 mm³
 SA = 46280.532 mm²

	(H)	(B)	(S)	(D)	(L)	(MM)	(MM)SPF550-VD (NCM)	(MC)	(TPP)	(LPM)	(3DP)	(3DP)DMM service
JIS B 0405	Division	0.5~3	3~6	6~30	30~120	120~400	400~1000	1000~2000	2000~4000	Note		
	f	±0.05	±0.05	±0.1	±0.15	±0.2	±0.3	±0.5				
	m	±0.1	±0.1	±0.2	±0.3	±0.5	±0.8	±1.2	±2			
	c	±0.2	±0.3	±0.5	±0.8	±1.2	±2	±3	±4			
	v		±0.5	±1	±1.5	±2.5	±4	±6	±8			

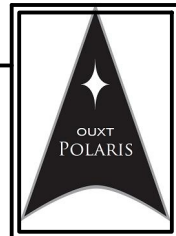

Worker
T.sanada
Worker's Signature

Deadline
2013/12/27
 Total Process Time
 [min./unit]

Completion Date
2013/12/27
Designer's Signature

Qty. **2**
 Sheet Size A3
 Pages 3 / 21

Material アルミニウム 5052			
Designer T.sanada	Date 2013/12/10	Rev. 2	Status リリース
ProjectName / AssemblyName MaritimeRobotX2014 / RearProp			
PartName ClumpPlate			
Drawing No. MRX14-RP-P002			

Model Path = C:\Users\Tatsuya\GoogleDrive\OUXT\InventorProjects\MRX14\RearProp_1st\RubberSheet1.ipt
 Drawing Path = C:\Users\Tatsuya\GoogleDrive\OUXT\InventorProjects\MRX14\RearProp_1st\Drawing\RearProp.idw

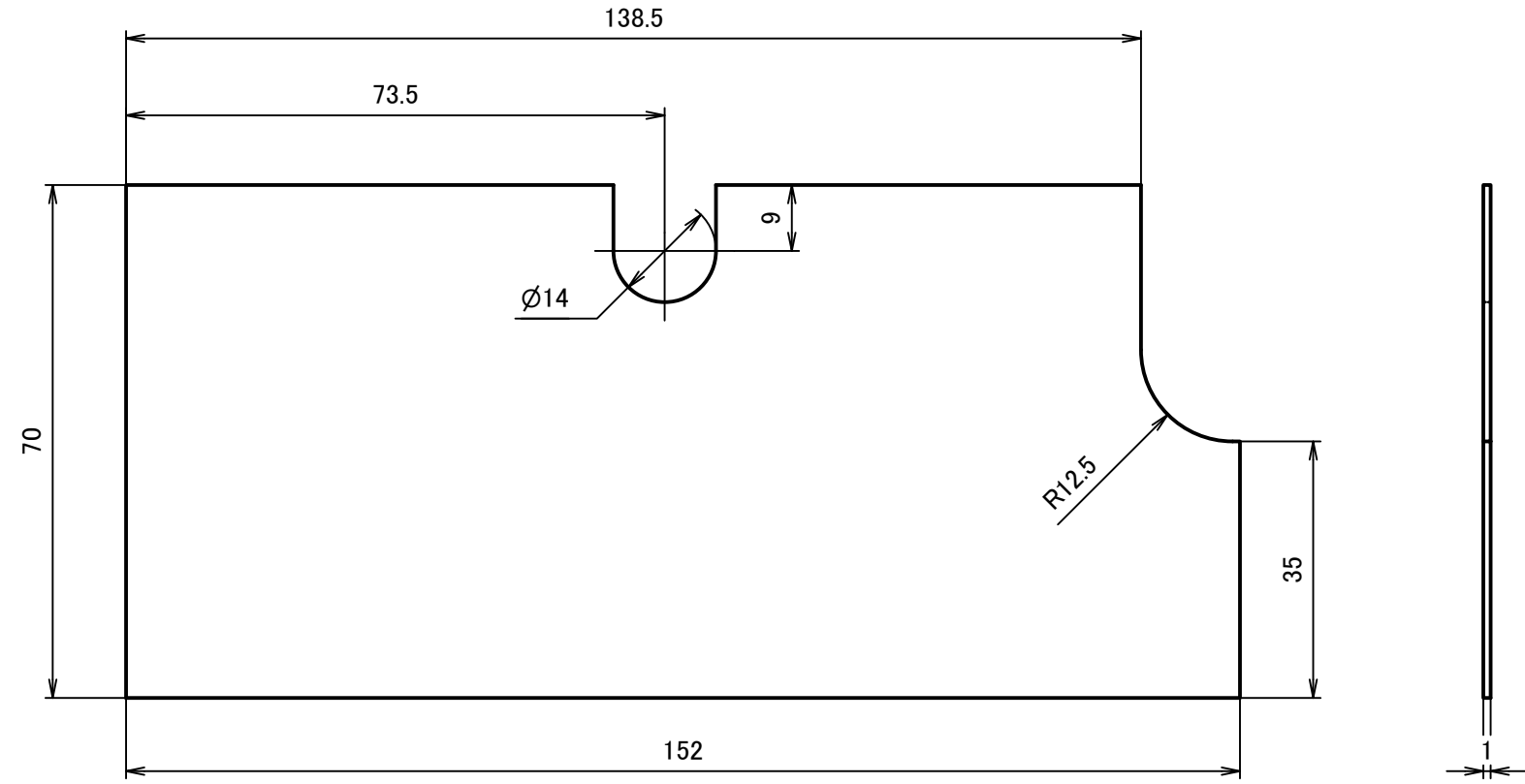

M = 9.298 g
 V = 9998.063 mm³
 SA = 20460.751 mm²

	(H)	(B)	(S)	(D)	(L)	(MM)	(MM)SPF550-VD (NCM)	(MC)	(TPP)	(LPM)	(3DP)	(3DP)DMM service
JIS B 0405	Division	0.5~3	3~6	6~30	30~120	120~400	400~1000	1000~2000	2000~4000	Note		
	f	±0.05	±0.05	±0.1	±0.15	±0.2	±0.3	±0.5				
	m	±0.1	±0.1	±0.2	±0.3	±0.5	±0.8	±1.2	±2			
	c	±0.2	±0.3	±0.5	±0.8	±1.2	±2	±3	±4			
	v		±0.5	±1	±1.5	±2.5	±4	±6	±8			

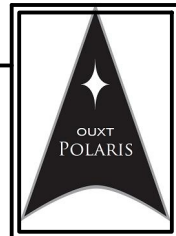

Worker
T.sanada
Worker's Signature

Deadline
2013/12/27
Total Process Time
[min./unit]

Completion Date
2013/12/27
Designer's Signature

Qty.
2
Sheet Size A3
Pages 4 / 21

Material	ゴム					
Designer	T.sanada	Date	2013/12/26	Rev. 2	Status	リリース
ProjectName / AssemblyName	MaritimeRobotX2014 / RearProp					
PartName	RubberSheet1					
Drawing No.	MRX14-RP-P003					

Model Path = C:\Users\Tatsuya\GoogleDrive\OUXT\InventorProjects\MRX14\RearProp_1st\RubberSheet2.ipt
 Drawing Path = C:\Users\Tatsuya\GoogleDrive\OUXT\InventorProjects\MRX14\RearProp_1st\Drawing\RearProp.idw

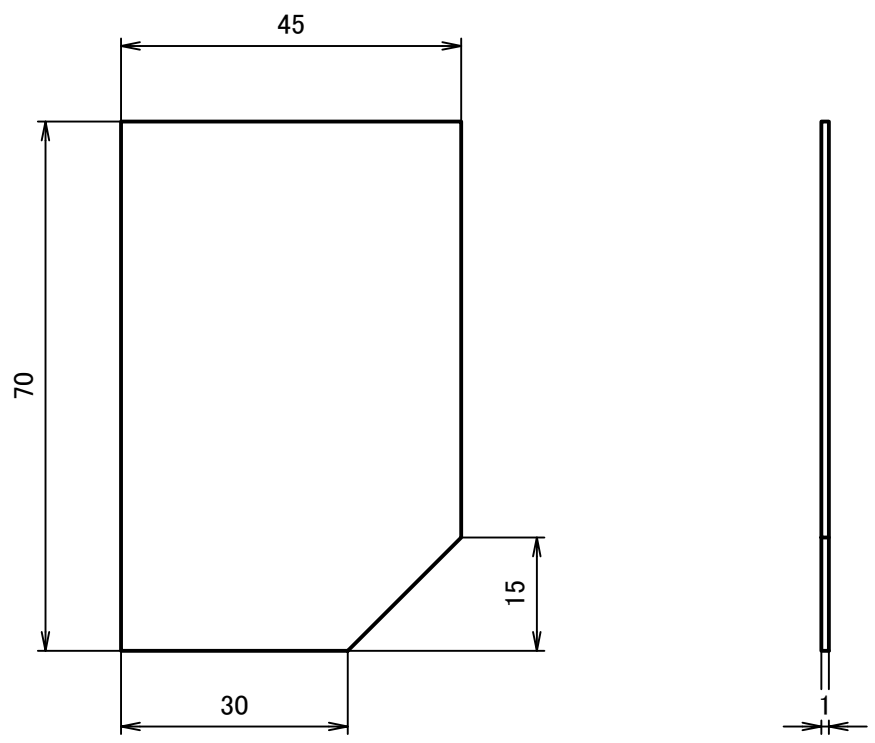

M = 2.825 g
 V = 3037.500 mm³
 SA = 6296.213 mm²

	(H)	(B)	(S)	(D)	(L)	(MM)	(MM)SPF550-VD (NCM)	(MC)	(TPP)	(LPM)	(3DP)	(3DP)DMM service
Division	0.5~3	3~6	6~30	30~120	120~400	400~1000	1000~2000	2000~4000	Note			
f	±0.05	±0.05	±0.1	±0.15	±0.2	±0.3	±0.5					
m	±0.1	±0.1	±0.2	±0.3	±0.5	±0.8	±1.2	±2				
c	±0.2	±0.3	±0.5	±0.8	±1.2	±2	±3	±4				
v		±0.5	±1	±1.5	±2.5	±4	±6	±8				

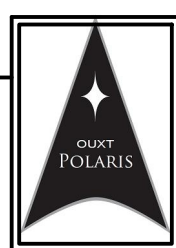

Worker T.sanada	Deadline 2013/12/27	Completion Date 2013/12/27	Qty. 2	Material ゴム
Worker's Signature	Total Process Time [min./unit]	Designer's Signature	Designer T.sanada	Date 2013/12/13
			Rev. 1	Status リリース
			ProjectName / AssemblyName MaritimeRobotX2014 / RearProp	
			PartName RubberSheet2	
			Drawing No. MRX14-RP-P004	
			SheetSize A3	
			Pages 5 / 21	

Model Path = C:\Users\Tatsuya\GoogleDrive\OUXT\InventorProjects\MRX14\RearProp_1st\RubberSheet3.ipt
 Drawing Path = C:\Users\Tatsuya\GoogleDrive\OUXT\InventorProjects\MRX14\RearProp_1st\Drawing\RearProp.idw

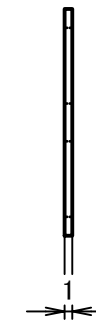
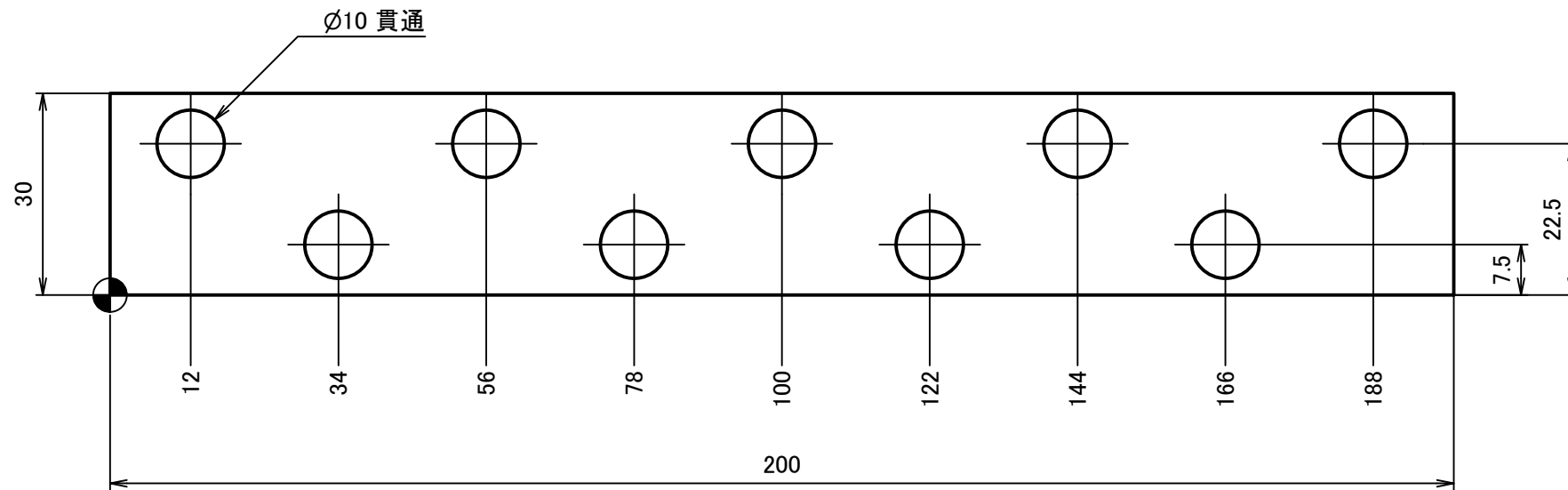

M = 4.923 g
 V = 5293.142 mm³
 SA = 11329.027 mm²

	(H)	(B)	(S)	(D)	(L)	(MM)	(MM)SPF550-VD (NCM)	(MC)	(TPP)	(LPM)	(3DP)	(3DP)DMM service
JIS B 0405	Division	0.5~3	3~6	6~30	30~120	120~400	400~1000	1000~2000	2000~4000	Note		
	f	±0.05	±0.05	±0.1	±0.15	±0.2	±0.3	±0.5				
	m	±0.1	±0.1	±0.2	±0.3	±0.5	±0.8	±1.2	±2			
	c	±0.2	±0.3	±0.5	±0.8	±1.2	±2	±3	±4			
	v		±0.5	±1	±1.5	±2.5	±4	±6	±8			

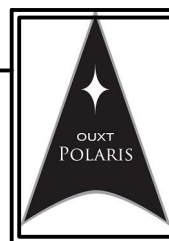

Worker
T.sanada
Worker's Signature

Deadline
2013/12/27
Total Process Time
[min./unit]

Completion Date
2013/12/27
Designer's Signature

Qty.
2
Sheet Size A3
Pages 6 / 21

Material ゴム			
Designer T.sanada	Date 2013/12/26	Rev. 2	Status リリース
ProjectName / AssemblyName MaritimeRobotX2014 / RearProp			
PartName RubberSheet3			
Drawing No. MRX14-RP-P005			

Model Path = C:\Users\Tatsuya\GoogleDrive\OUXT\InventorProjects\MRX14\RearProp_1st\MountPlate.ipt
 Drawing Path = C:\Users\Tatsuya\GoogleDrive\OUXT\InventorProjects\MRX14\RearProp_1st\Drawing\RearProp.idw

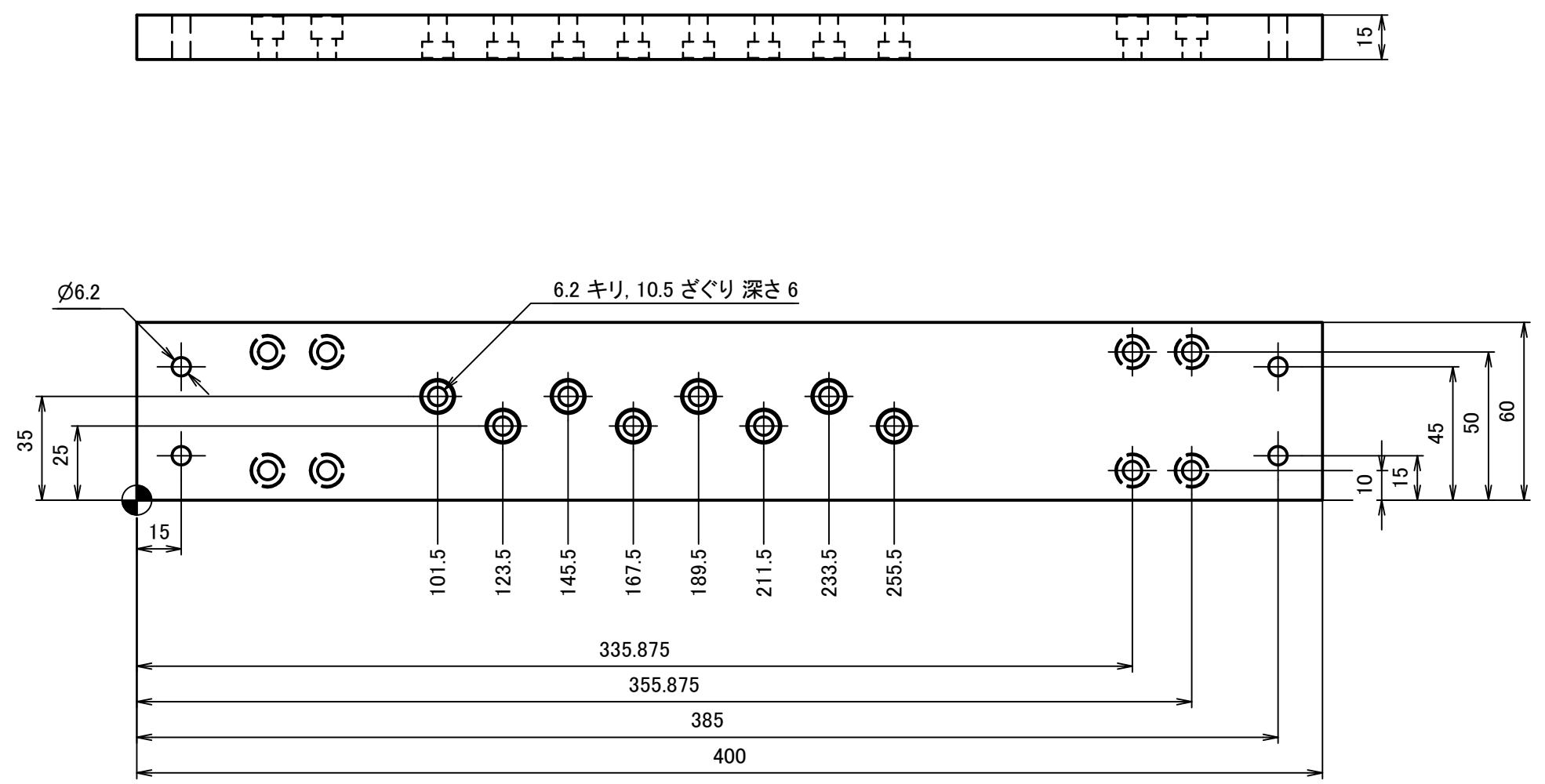

M = 923.415 g
 V = 344557.983 mm³
 SA = 67799.345 mm²

	(H)	(B)	(S)	(D)	(L)	(MM)	(MM)SPF550-VD (NCM)	(MC)	(TPP)	(LPM)	(3DP)	(3DP)DMM service
JIS B 0405	Division	0.5~3	3~6	6~30	30~120	120~400	400~1000	1000~2000	2000~4000	Note		
	f	±0.05	±0.05	±0.1	±0.15	±0.2	±0.3	±0.5				
	m	±0.1	±0.1	±0.2	±0.3	±0.5	±0.8	±1.2	±2			
	c	±0.2	±0.3	±0.5	±0.8	±1.2	±2	±3	±4			
	v		±0.5	±1	±1.5	±2.5	±4	±6	±8			

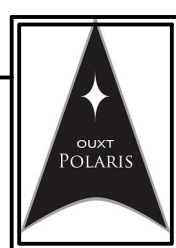

Worker T.sanada	Deadline 2013/12/27	Completion Date 2013/12/27	Qty. 2	Material アルミニウム 5052
Worker's Signature	Total Process Time [min./unit]	Designer's Signature	SheetSize A3	Designer T.sanada
			Pages 8 / 21	Date 2013/12/16
				Rev. 2
				Status リリース
				ProjectName / AssemblyName MaritimeRobotX2014 / RearProp
				PartName MountPlate
				Drawing No. MRX14-RP-P007

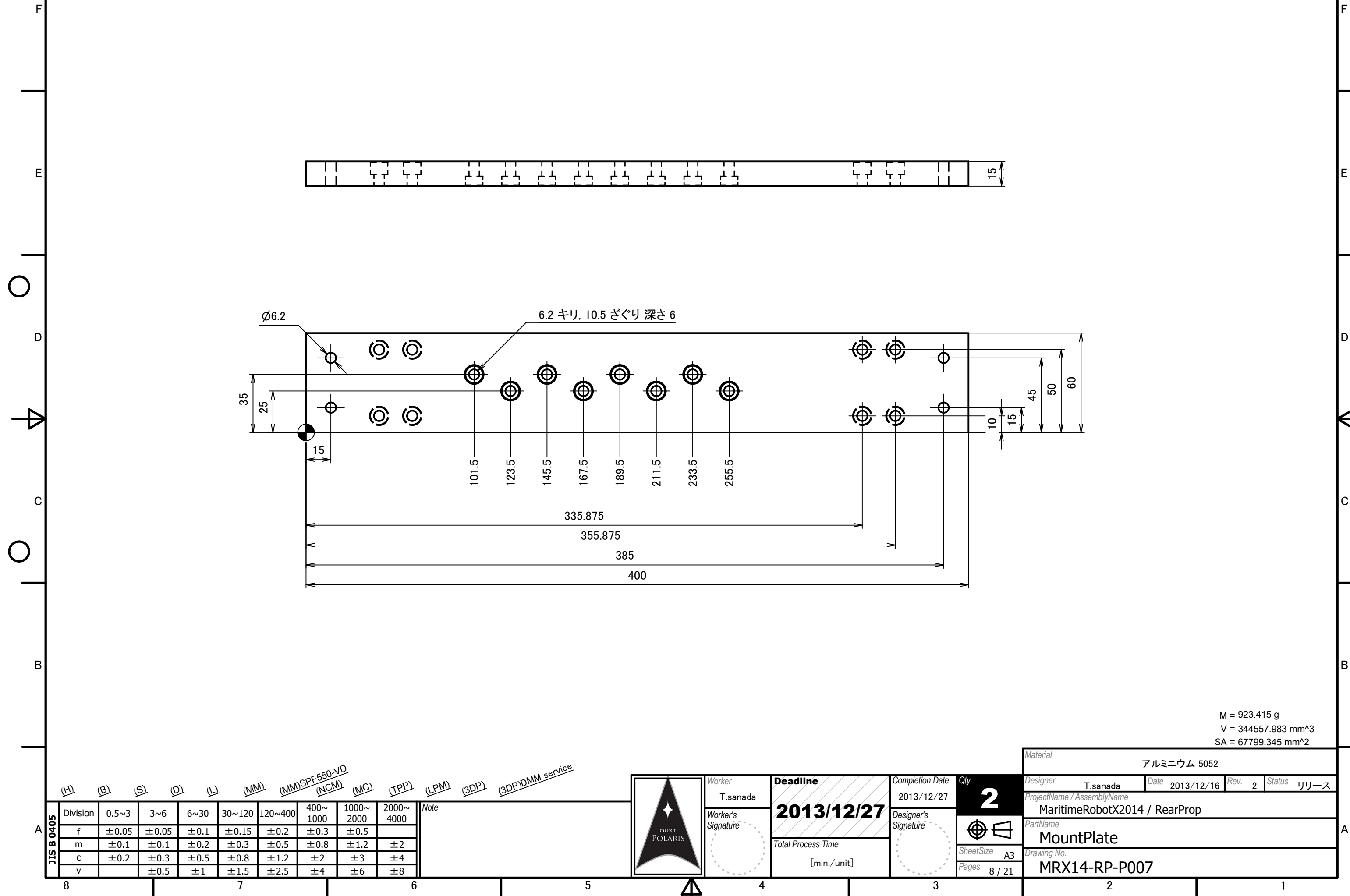

Model Path = C:\Users\Tatsuya\GoogleDrive\OUXT\InventorProjects\MRX14\RearProp_1st\ShaftHolder1.ipt
 Drawing Path = C:\Users\Tatsuya\GoogleDrive\OUXT\InventorProjects\MRX14\RearProp_1st\Drawing\RearProp.idw

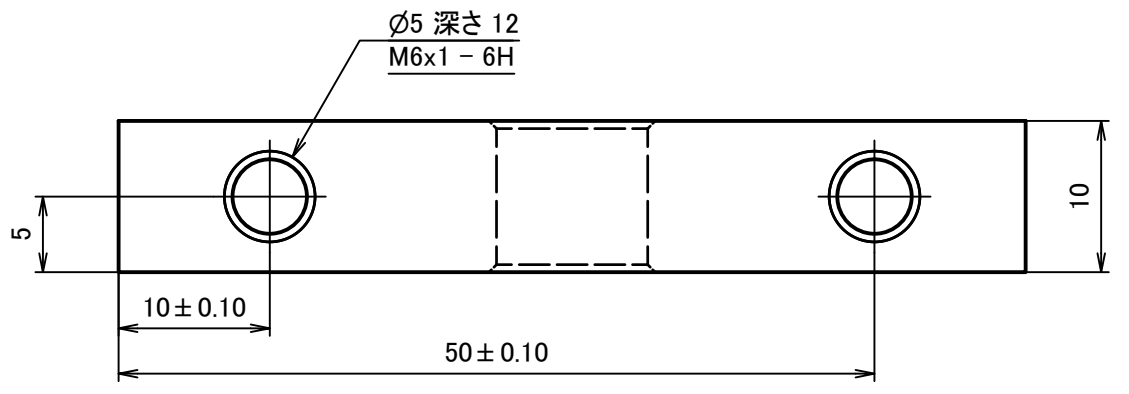
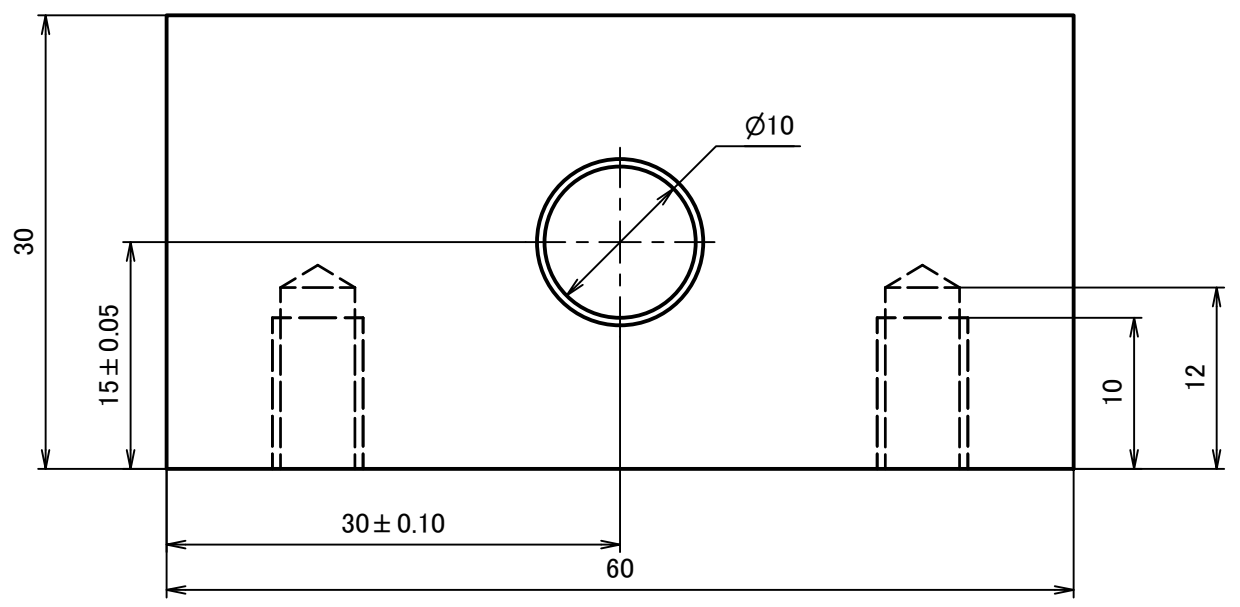

M = 44.842 g
 V = 16732.062 mm³
 SA = 5916.389 mm²

	(H)	(B)	(S)	(D)	(L)	(MM)	(MM)SPF550-VD (NCM)	(MC)	(TPP)	(LPM)	(3DP)	(3DP)DMM service
Division	0.5~3	3~6	6~30	30~120	120~400	400~1000	1000~2000	2000~4000	Note			
f	±0.05	±0.05	±0.1	±0.15	±0.2	±0.3	±0.5					
m	±0.1	±0.1	±0.2	±0.3	±0.5	±0.8	±1.2	±2				
c	±0.2	±0.3	±0.5	±0.8	±1.2	±2	±3	±4				
v		±0.5	±1	±1.5	±2.5	±4	±6	±8				

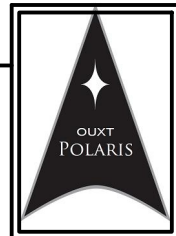

Worker
T.sanada
Worker's Signature

Deadline
2013/12/27
Total Process Time
[min./unit]

Completion Date
2013/12/27
Designer's Signature

Qty.
8
Sheet Size A3
Pages 9 / 21

Material	アルミニウム 5052			
Designer	T.sanada	Date	2013/12/13	Rev. 2
ProjectName / AssemblyName	MaritimeRobotX2014 / RearProp			
PartName	ShaftHolder1			
Drawing No.	MRX14-RP-P008			

F
E
D
C
B
A

F
E
D
C
B
A

8 7 6 5 4 3 2 1

8 7 6 5 4 3 2 1

Model Path = C:\Users\Tatsuya\GoogleDrive\OUXT\InventorProjects\MRX14\RearProp_1st\LinkRod.ipt
 Drawing Path = C:\Users\Tatsuya\GoogleDrive\OUXT\InventorProjects\MRX14\RearProp_1st\Drawing\RearProp.idw

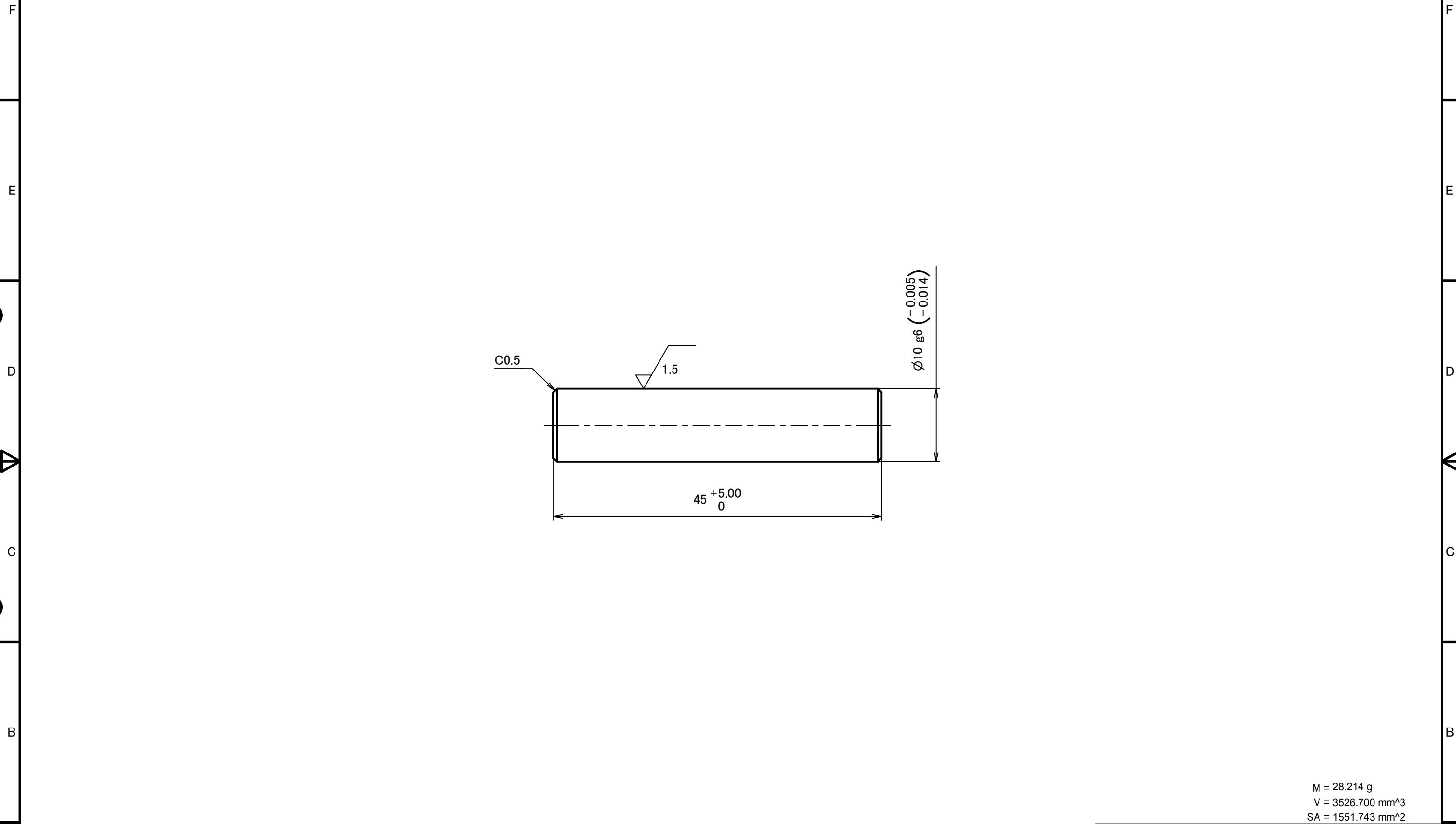

M = 28.214 g
 V = 3526.700 mm³
 SA = 1551.743 mm²

	(H)	(B)	(S)	(D)	(L)	(MM)	(MM)SPF550-VD (NCM)	(MC)	(TPP)	(LPM)	(3DP)	(3DP)DMM service
JIS B 0405	Division	0.5~3	3~6	6~30	30~120	120~400	400~1000	1000~2000	2000~4000	Note		
	f	±0.05	±0.05	±0.1	±0.15	±0.2	±0.3	±0.5				
	m	±0.1	±0.1	±0.2	±0.3	±0.5	±0.8	±1.2	±2			
	c	±0.2	±0.3	±0.5	±0.8	±1.2	±2	±3	±4			
	v		±0.5	±1	±1.5	±2.5	±4	±6	±8			

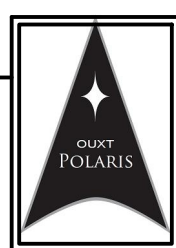

Worker T.sanada	Deadline 2013/12/27	Completion Date 2013/12/27	Qty. 8	Material SUJ2
Worker's Signature	Total Process Time [min./unit]	Designer's Signature	SheetSize A3	Designer T.sanada
			Pages 10 / 21	Date 2013/12/16
				Rev. 1
				Status リリース
				ProjectName / AssemblyName MaritimeRobotX2014 / RearProp
				PartName LinkRod
				Drawing No. MRX14-RP-P009

8 7 6 5 4 3 2 1

8 7 6 5 4 3 2 1

Model Path = C:\Users\Tatsuya\GoogleDrive\OUXT\InventorProjects\MRX14\RearProp_1st\UpperArmSqRod.ipt
 Drawing Path = C:\Users\Tatsuya\GoogleDrive\OUXT\InventorProjects\MRX14\RearProp_1st\Drawing\RearProp.idw

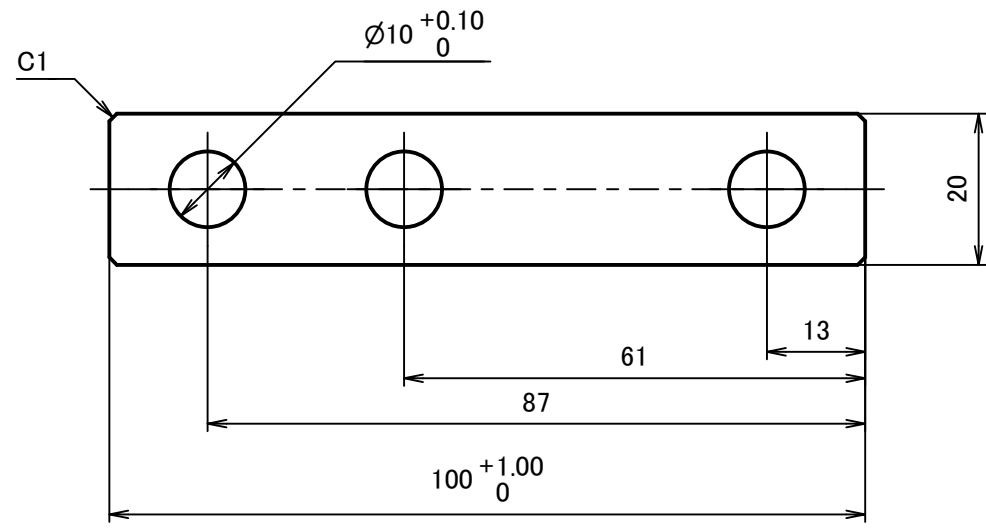
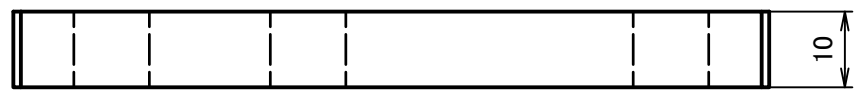

M = 47.232 g
 V = 17623.806 mm³
 SA = 6843.807 mm²

Material				アルミニウム 5052			
Designer	T.sanada	Date	2015/03/23	Rev.	2	Status	リリース
ProjectName / AssemblyName							
MaritimeRobotX2014 / RearProp							
PartName							
UpperArmSqRod							
Drawing No.							
MRX14-RP-P010							

	(H)	(B)	(S)	(D)	(L)	(MM)	(MM)SPF550-VD (NCM)	(MC)	(TPP)	(LPM)	(3DP)	(3DP)DMM service	Note
JIS B 0405	Division	0.5~3	3~6	6~30	30~120	120~400	400~1000	1000~2000	2000~4000				
	f	±0.05	±0.05	±0.1	±0.15	±0.2	±0.3	±0.5					
	m	±0.1	±0.1	±0.2	±0.3	±0.5	±0.8	±1.2	±2				
	c	±0.2	±0.3	±0.5	±0.8	±1.2	±2	±3	±4				
	v		±0.5	±1	±1.5	±2.5	±4	±6	±8				

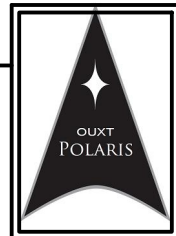

Worker
T.sanada
Worker's Signature

Deadline
2013/12/27
Total Process Time
[min./unit]

Completion Date
2013/12/27
Designer's Signature

Qty.
4
Sheet Size A3
Pages 11 / 21

F
E
D
C
B
A

F
E
D
C
B
A

8 7 6 5 4 3 2 1

Model Path = C:\Users\Tatsuya\GoogleDrive\OUXT\InventorProjects\MRX14\RearProp_1st\BottomLinkUnit.iam
 Drawing Path = C:\Users\Tatsuya\GoogleDrive\OUXT\InventorProjects\MRX14\RearProp_1st\Drawing\RearProp.idw

部品表		
項目	部品番号	数量
1	MotorClumpedPlate	1
2	HingeTonguePlateUnit	1
3	BottomLinkBase_L	1
4	BottomLinkBase_R	1
5	BottomArmCommonUnit	2
6	JIS B 1256 - 8x15.5	12
7	JIS B 1176 - M8 x 50	6
8	JIS B 1181 - A/B M8	6
9	JIS B 1181 - A/B M6	8
10	JIS B 1256 - 6x12.5	16
11	JIS B 1180 - M6x60	8

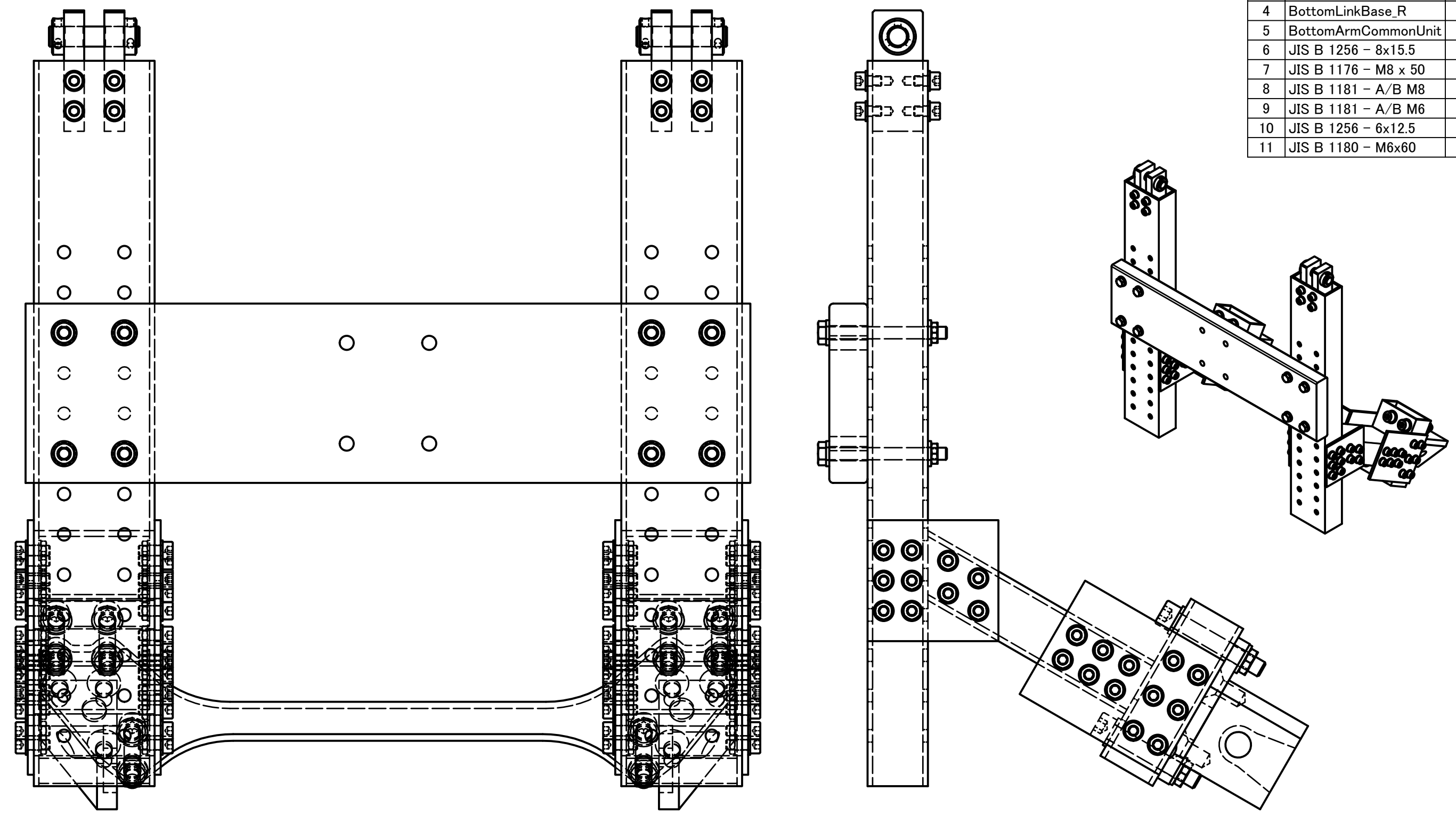

M = 3551.126 g
 V = 1519903.815 mm³
 SA = 764155.066 mm²

	(H)	(B)	(S)	(D)	(L)	(MM)	(MM)SPF550-VD (NCM)	(MC)	(TPP)	(LPM)	(3DP)	(3DP)DMM service
Division	0.5~3	3~6	6~30	30~120	120~400	400~1000	1000~2000	2000~4000	Note			
f	±0.05	±0.05	±0.1	±0.15	±0.2	±0.3	±0.5					
m	±0.1	±0.1	±0.2	±0.3	±0.5	±0.8	±1.2	±2				
c	±0.2	±0.3	±0.5	±0.8	±1.2	±2	±3	±4				
v		±0.5	±1	±1.5	±2.5	±4	±6	±8				

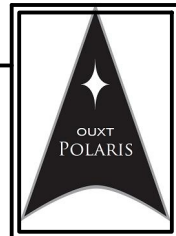

Worker
T.sanada
Worker's Signature

Deadline
2013/12/27
Total Process Time
[min./unit]

Completion Date
2013/12/27
Designer's Signature

Qty.
2
SheetSize A3
Pages 12 / 21

Material	Designer T.sanada	Date 2015/03/23	Rev. 1	Status リリース
ProjectName / AssemblyName MaritimeRobotX2014 / RearProp				
PartName BottomLinkArmUnit				
Drawing No. MRX14-RP-A002				

Model Path = C:\Users\Tatsuya\GoogleDrive\OUXT\InventorProjects\MRX14\RearProp_1st\BottomArmCommonUnit.iam
 Drawing Path = C:\Users\Tatsuya\GoogleDrive\OUXT\InventorProjects\MRX14\RearProp_1st\Drawing\RearProp.idw

部品表		
項目	部品番号	数量
1	BottomArmVerticalSqPipe	1
2	BottomArmSlantingSqPipe	1
3	BottomArmFixingPlate1	2
4	JIS B 1256 - 5x10	96
5	JIS B 1181 - A/B M5	44
6	JIS B 1176 - M5 x 12	44
7	BottomArmFixingPlate2	2
8	ShaftHolder2	2
9	JIS B 1176 - M5 x 8	8
10	SC1006A	2
11	LinkRod	1

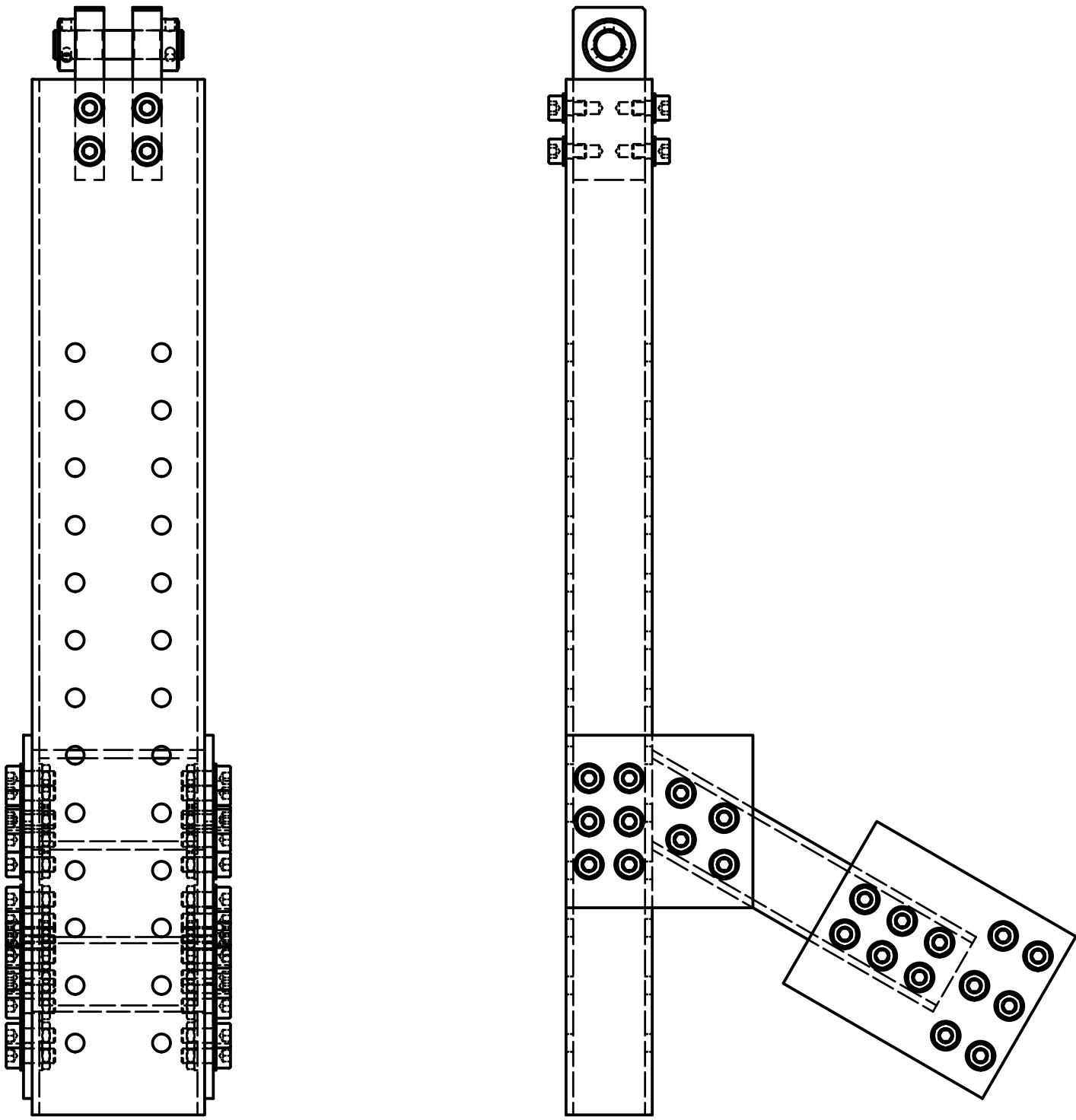

M = 1053.723 g
 V = 317508.468 mm³
 SA = 265048.945 mm²

	(H)	(B)	(S)	(D)	(L)	(MM)	(MM)SPF550-VD (NCM)	(MC)	(TPP)	(LPM)	(3DP)	(3DP)DMM service
Division	0.5~3	3~6	6~30	30~120	120~400	400~1000	1000~2000	2000~4000	Note			
f	±0.05	±0.05	±0.1	±0.15	±0.2	±0.3	±0.5					
m	±0.1	±0.1	±0.2	±0.3	±0.5	±0.8	±1.2	±2				
c	±0.2	±0.3	±0.5	±0.8	±1.2	±2	±3	±4				
v		±0.5	±1	±1.5	±2.5	±4	±6	±8				

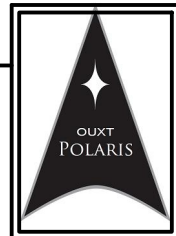

Worker
T.sanada
Worker's Signature

Deadline
2013/12/27
Total Process Time
[min./unit]

Completion Date
2013/12/27
Designer's Signature

Qty.
4
Sheet Size A3
Pages 13 / 21

Material	Designer T.sanada	Date 2015/03/23	Rev. 1	Status リリース
ProjectName / AssemblyName MaritimeRobotX2014 / RearProp				
PartName BottomArmCommonUnit				
Drawing No. MRX14-RP-A003				

Model Path = C:\Users\Tatsuya\GoogleDrive\OUXT\InventorProjects\MRX14\RearProp_1st\ShaftHolder2.ipt
 Drawing Path = C:\Users\Tatsuya\GoogleDrive\OUXT\InventorProjects\MRX14\RearProp_1st\Drawing\RearProp.idw

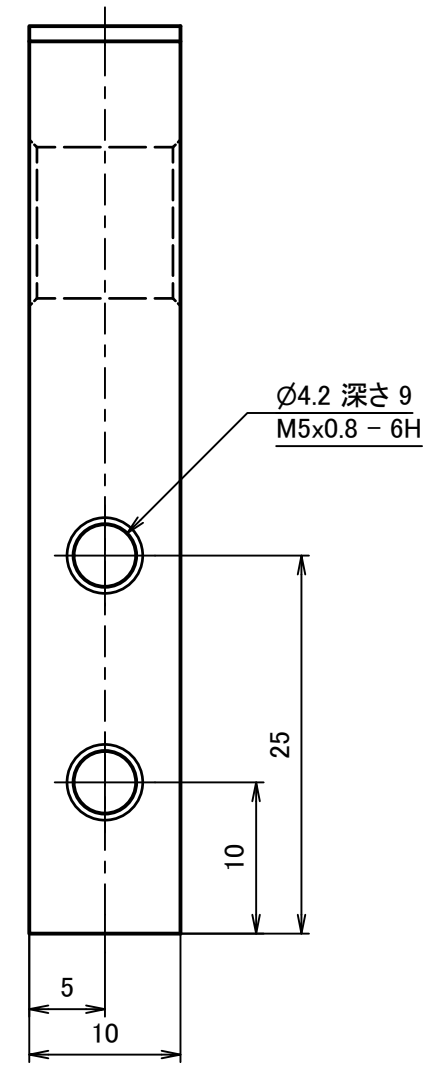
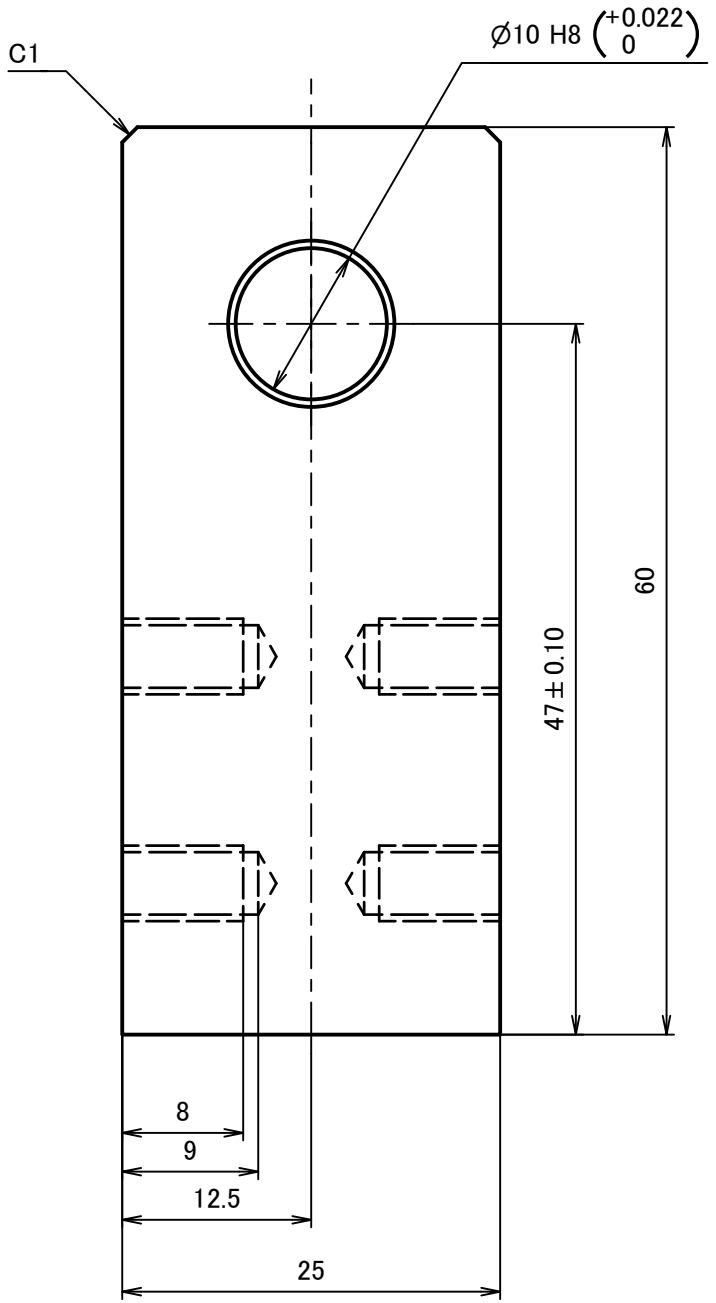

M = 36.694 g
 V = 13691.921 mm³
 SA = 5301.462 mm²

	(H)	(B)	(S)	(D)	(L)	(MM)	(MM)SPF550-VD (NCM)	(MC)	(TPP)	(LPM)	(3DP)	(3DP)DMM service
Division	0.5~3	3~6	6~30	30~120	120~400	400~1000	1000~2000	2000~4000	Note			
f	±0.05	±0.05	±0.1	±0.15	±0.2	±0.3	±0.5					
m	±0.1	±0.1	±0.2	±0.3	±0.5	±0.8	±1.2	±2				
c	±0.2	±0.3	±0.5	±0.8	±1.2	±2	±3	±4				
v		±0.5	±1	±1.5	±2.5	±4	±6	±8				

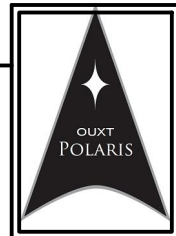

Worker
T.sanada
Worker's Signature

Deadline
2013/12/27
Total Process Time
[min./unit]

Completion Date
2013/12/27
Designer's Signature

Qty.
8
Sheet Size A3
Pages 14 / 21

Material アルミニウム 5052			
Designer T.sanada	Date 2013/12/12	Rev. 2	Status リリース
ProjectName / AssemblyName MaritimeRobotX2014 / RearProp			
PartName ShaftHolder2			
Drawing No. MRX14-RP-P011			

Model Path = C:\Users\Tatsuya\GoogleDrive\OUXT\InventorProjects\MRX14\RearProp_1st\BottomLinkBase_R.ipt
 Drawing Path = C:\Users\Tatsuya\GoogleDrive\OUXT\InventorProjects\MRX14\RearProp_1st\Drawing\RearProp.idw

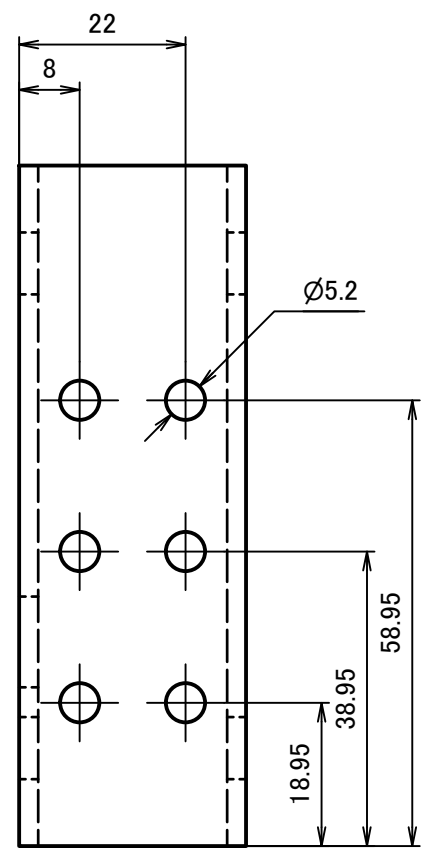
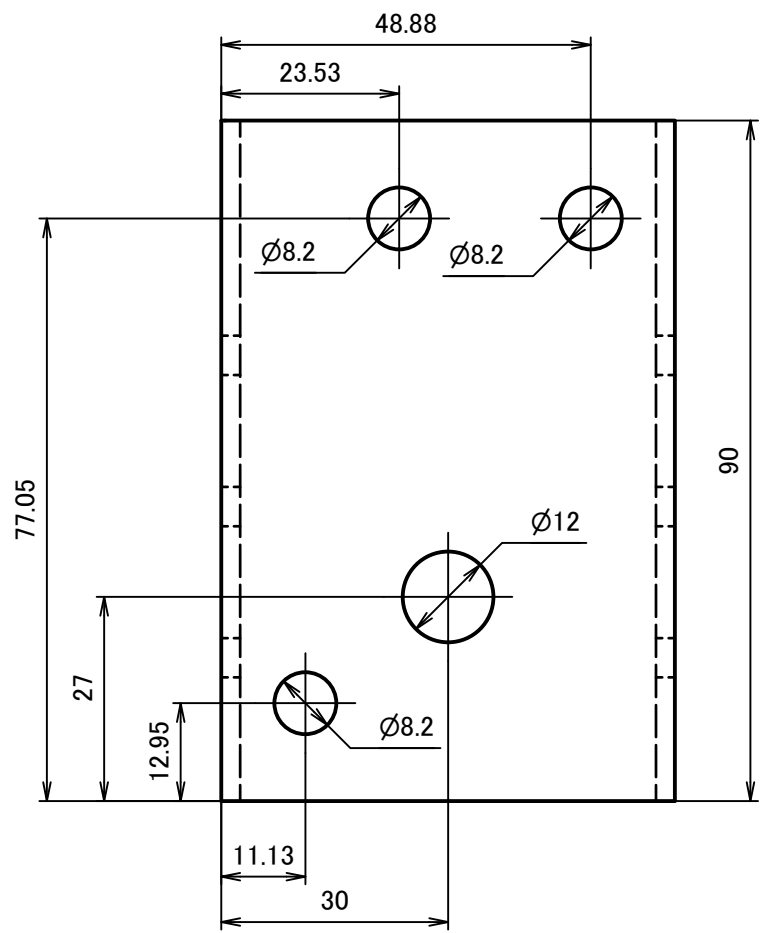
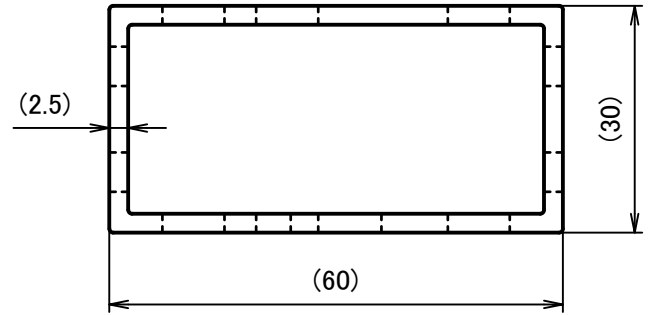

M = 99.018 g
 V = 36537.989 mm³
 SA = 30896.630 mm²

	(H)	(B)	(S)	(D)	(L)	(MM)	(MM)SPF550-VD (NCM)	(MC)	(TPP)	(LPM)	(3DP)	(3DP)DMM service
Division	0.5~3	3~6	6~30	30~120	120~400	400~1000	1000~2000	2000~4000	Note			
f	±0.05	±0.05	±0.1	±0.15	±0.2	±0.3	±0.5					
m	±0.1	±0.1	±0.2	±0.3	±0.5	±0.8	±1.2	±2				
c	±0.2	±0.3	±0.5	±0.8	±1.2	±2	±3	±4				
v		±0.5	±1	±1.5	±2.5	±4	±6	±8				

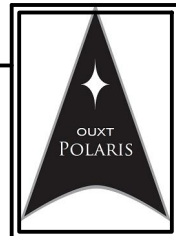

Worker
T.sanada
Worker's Signature

Deadline
2013/12/27
Total Process Time
[min./unit]

Completion Date
2013/12/27
Designer's Signature

Qty. **2**
Sheet Size A3
Pages 15 / 21

Material	アルミニウム 6061			
Designer	T.sanada	Date	2013/12/19	Rev. 2
ProjectName / AssemblyName	MaritimeRobotX2014 / RearProp			
PartName	BottomLinkBase_R			
Drawing No.	MRX14-RP-P012			
Status	リリース			

Model Path = C:\Users\Tatsuya\GoogleDrive\OUXT\InventorProjects\MRX14\RearProp_1st\BottomLinkBase_L.ipt
 Drawing Path = C:\Users\Tatsuya\GoogleDrive\OUXT\InventorProjects\MRX14\RearProp_1st\Drawing\RearProp.idw

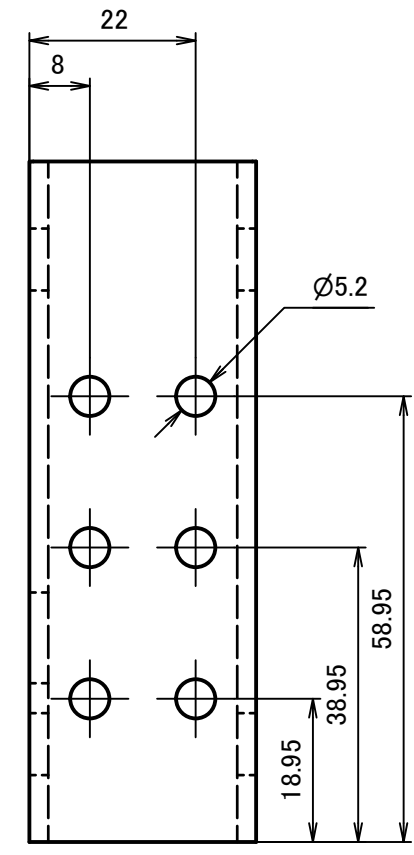
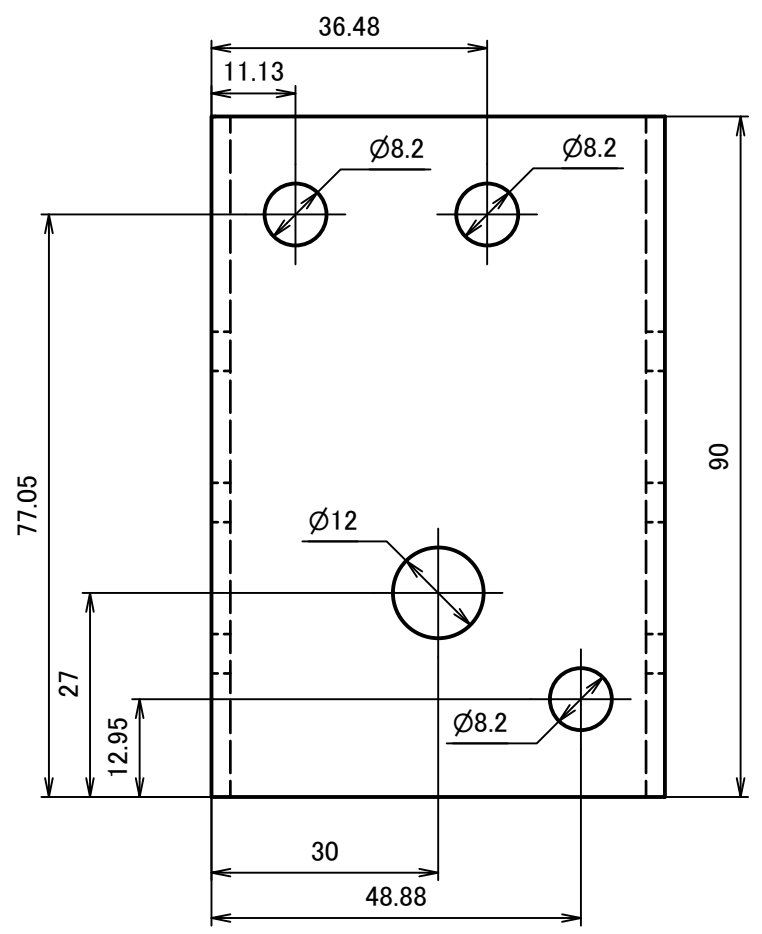
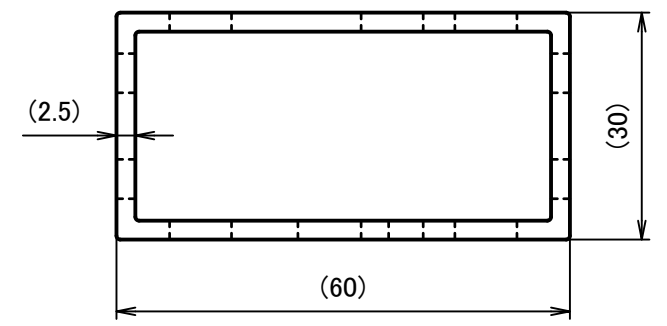

M = 99.018 g
 V = 36537.989 mm³
 SA = 30896.630 mm²

	(H)	(B)	(S)	(D)	(L)	(MM)	(MM)SPF550-VD (NCM)	(MC)	(TPP)	(LPM)	(3DP)	(3DP)DMM service
Division	0.5~3	3~6	6~30	30~120	120~400	400~1000	1000~2000	2000~4000	Note			
f	±0.05	±0.05	±0.1	±0.15	±0.2	±0.3	±0.5					
m	±0.1	±0.1	±0.2	±0.3	±0.5	±0.8	±1.2	±2				
c	±0.2	±0.3	±0.5	±0.8	±1.2	±2	±3	±4				
v		±0.5	±1	±1.5	±2.5	±4	±6	±8				

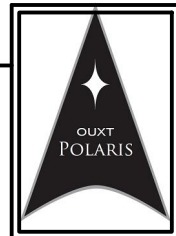

Worker
T.sanada
Worker's Signature

Deadline
2013/12/27
Total Process Time
[min./unit]

Completion Date
2013/12/27
Designer's Signature

Qty. **2**
SheetSize A3
Pages 16 / 21

Material	アルミニウム 6061					
Designer	T.sanada	Date	2013/12/22	Rev. 2	Status	リリース
ProjectName / AssemblyName	MaritimeRobotX2014 / RearProp					
PartName	BottomLinkBase_L					
Drawing No.	MRX14-RP-P013					

Model Path = C:\Users\Tatsuya\GoogleDrive\OUXT\InventorProjects\MRX14\RearProp_1st\BottomArmSlantingSqPipe.ipt
 Drawing Path = C:\Users\Tatsuya\GoogleDrive\OUXT\InventorProjects\MRX14\RearProp_1st\Drawing\RearProp.idw

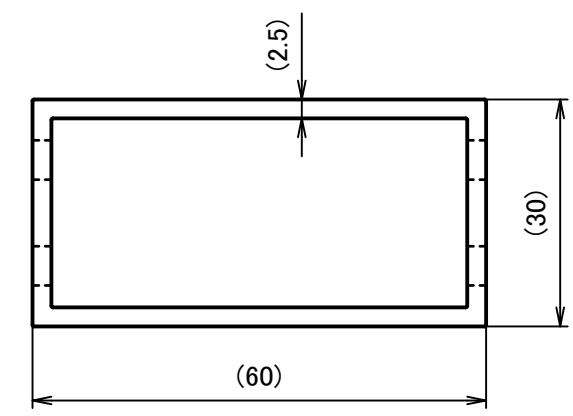
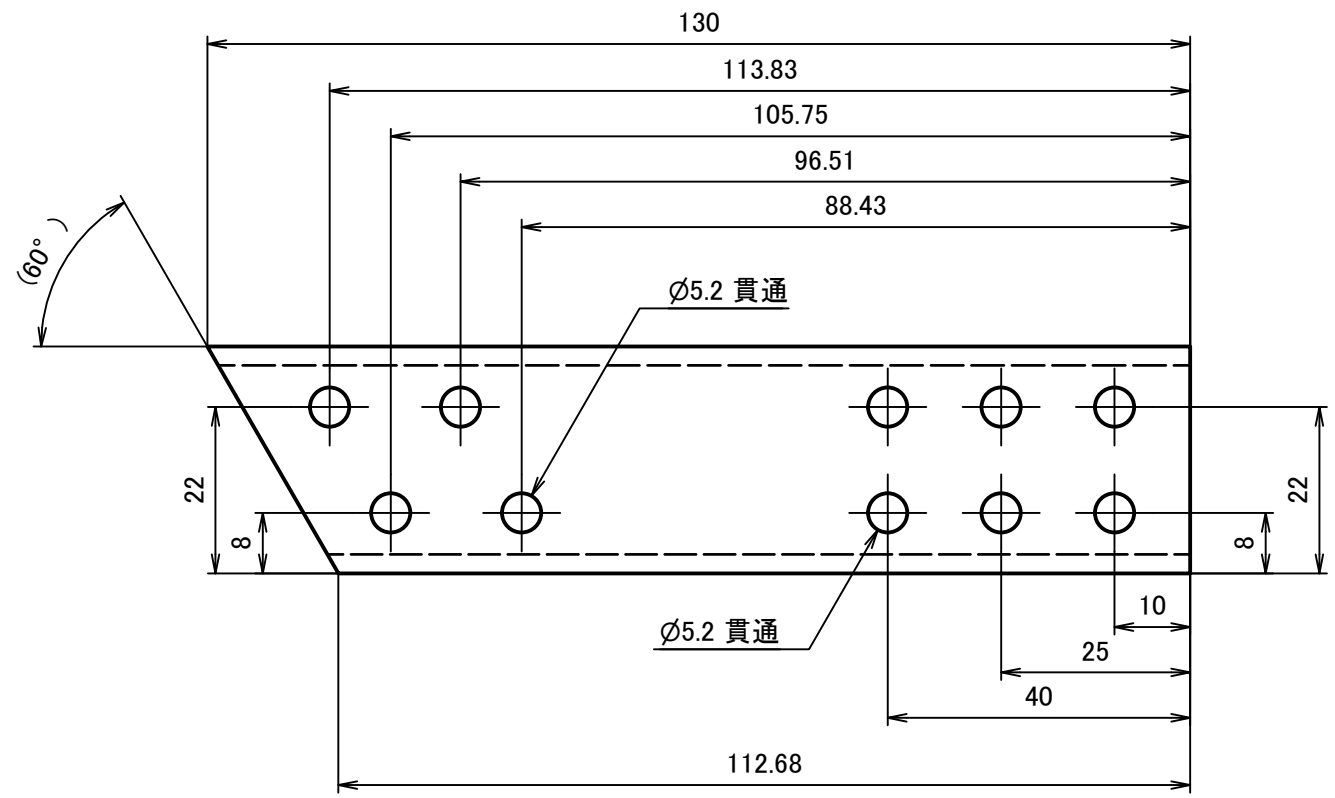

M = 136.875 g
 V = 50507.534 mm³
 SA = 42055.262 mm²

	(H)	(B)	(S)	(D)	(L)	(MM)	(MM)SPF550-VD (NCM)	(MC)	(TPP)	(LPM)	(3DP)	(3DP)DMM service
JIS B 0405	Division	0.5~3	3~6	6~30	30~120	120~400	400~1000	1000~2000	2000~4000	Note		
	f	±0.05	±0.05	±0.1	±0.15	±0.2	±0.3	±0.5				
	m	±0.1	±0.1	±0.2	±0.3	±0.5	±0.8	±1.2	±2			
	c	±0.2	±0.3	±0.5	±0.8	±1.2	±2	±3	±4			
	v		±0.5	±1	±1.5	±2.5	±4	±6	±8			

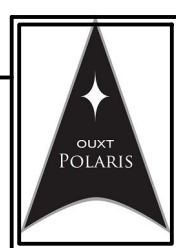

Worker T.sanada	Deadline 2013/12/27	Completion Date 2013/12/27	Qty. 4	Material アルミニウム 6061
Worker's Signature	Total Process Time [min./unit]	Designer's Signature	SheetSize A3	Designer T.sanada
			Pages 17 / 21	Date 2013/12/17
				Rev. 2
				Status リリース
				ProjectName / AssemblyName MaritimeRobotX2014 / RearProp
				PartName BottomArmSlantingSqPipe
				Drawing No. MRX14-RP-P014

Model Path = C:\Users\Tatsuya\GoogleDrive\OUXT\InventorProjects\MRX14\RearProp_1st\BottomArmFixingPlate2.ipt
 Drawing Path = C:\Users\Tatsuya\GoogleDrive\OUXT\InventorProjects\MRX14\RearProp_1st\Drawing\RearProp.idw

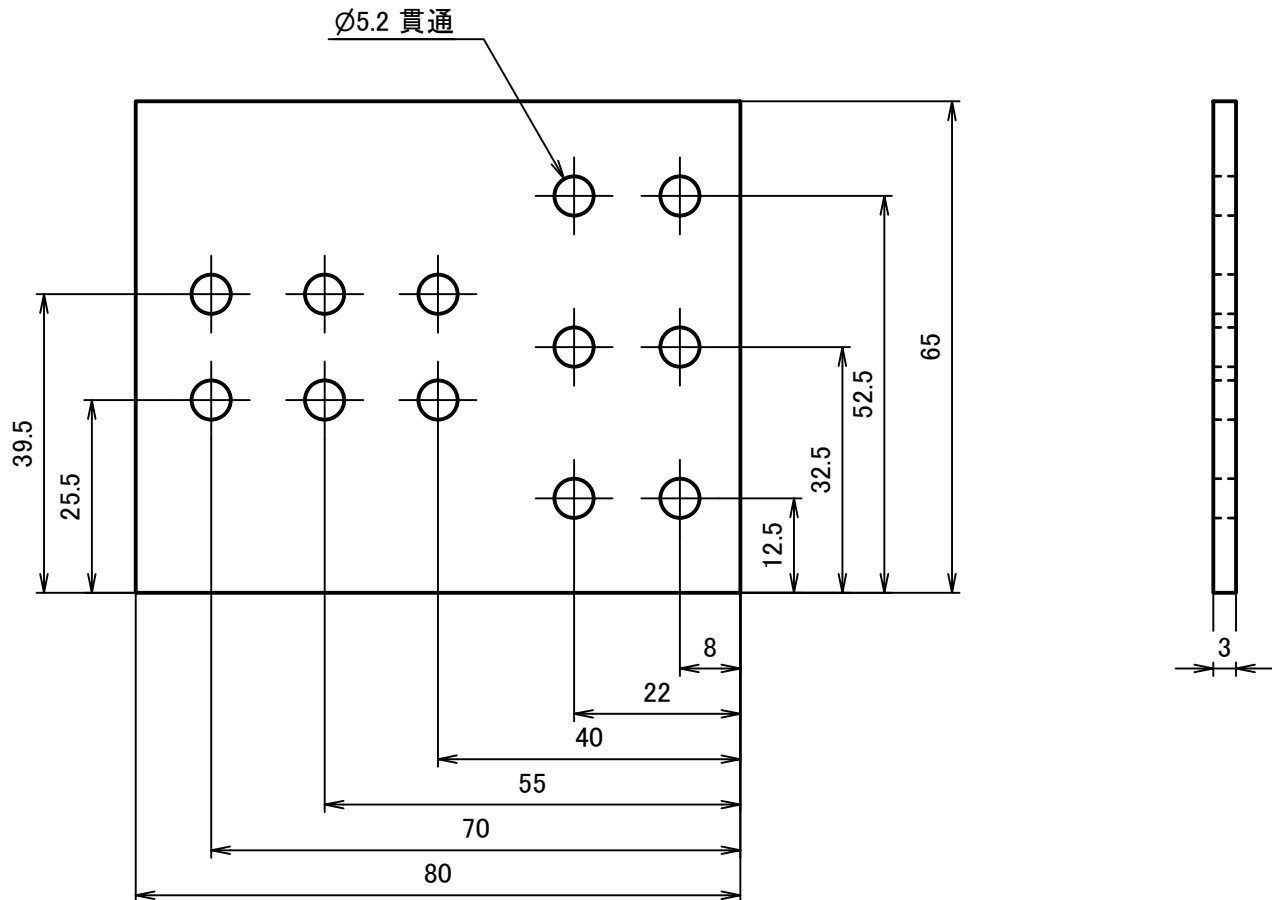

M = 39.759 g
 V = 14835.462 mm³
 SA = 11348.414 mm²

	(H)	(B)	(S)	(D)	(L)	(MM)	(MM)SPF550-VD (NCM)	(MC)	(TPP)	(LPM)	(3DP)	(3DP)DMM service
Division	0.5~3	3~6	6~30	30~120	120~400	400~1000	1000~2000	2000~4000	Note			
f	±0.05	±0.05	±0.1	±0.15	±0.2	±0.3	±0.5					
m	±0.1	±0.1	±0.2	±0.3	±0.5	±0.8	±1.2	±2				
c	±0.2	±0.3	±0.5	±0.8	±1.2	±2	±3	±4				
v		±0.5	±1	±1.5	±2.5	±4	±6	±8				

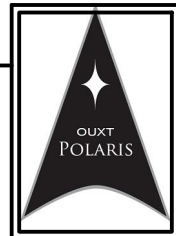

Worker
T.sanada
Worker's Signature

Deadline
2013/12/27
Total Process Time
[min./unit]

Completion Date
2013/12/27
Designer's Signature

Qty.
8
Sheet Size A3
Pages 18 / 21

Material アルミニウム 5052			
Designer T.sanada	Date 2013/12/17	Rev. 2	Status リリース
ProjectName / AssemblyName MaritimeRobotX2014 / RearProp			
PartName BottomArmFixingPlate2			
Drawing No. MRX14-RP-P015			

Model Path = C:\Users\Tatsuya\GoogleDrive\OUXT\InventorProjects\MRX14\RearProp_1st\BottomArmFixingPlate1.ipt
 Drawing Path = C:\Users\Tatsuya\GoogleDrive\OUXT\InventorProjects\MRX14\RearProp_1st\Drawing\RearProp.idw

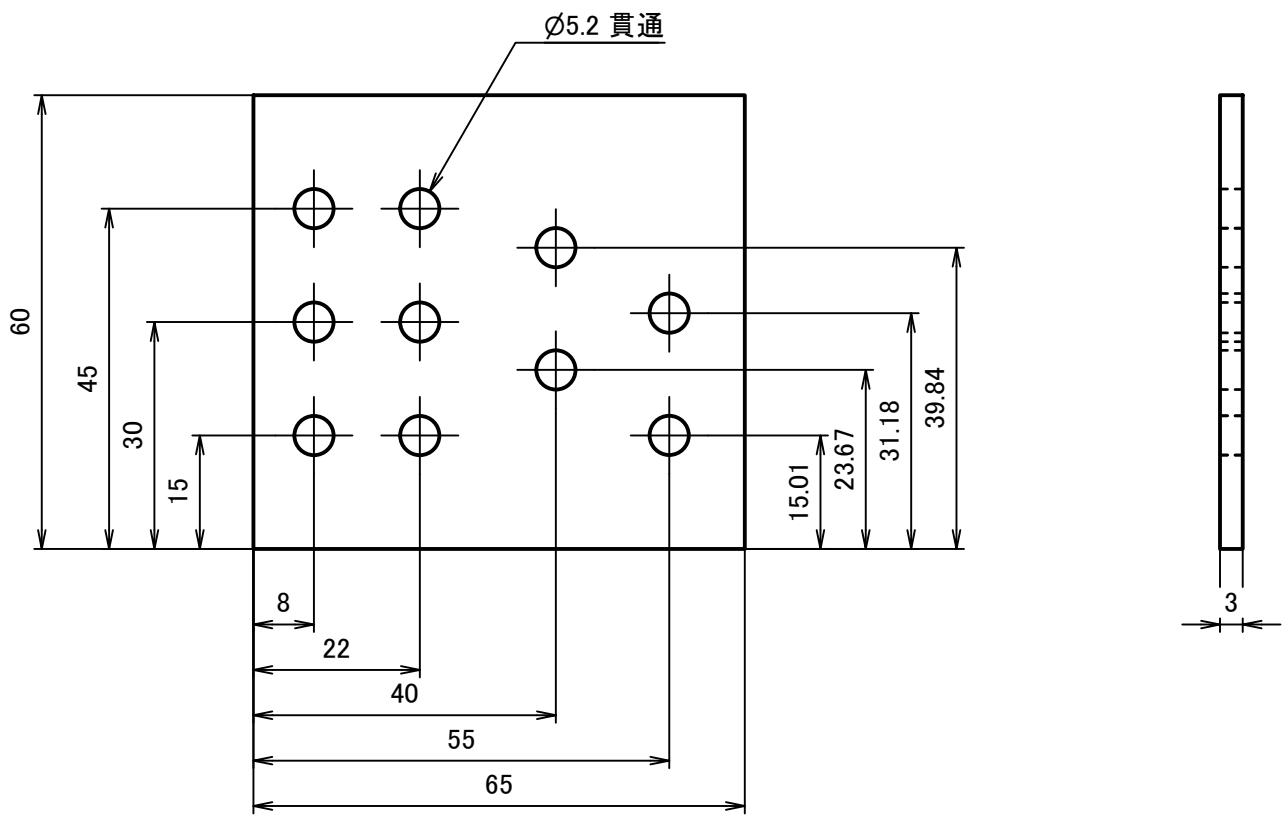

M = 29.649 g
 V = 11062.885 mm³
 SA = 8615.345 mm²

	(H)	(B)	(S)	(D)	(L)	(MM)	(MM)SPF550-VD (NCM)	(MC)	(TPP)	(LPM)	(3DP)	(3DP)DMM service
JIS B 0405	Division	0.5~3	3~6	6~30	30~120	120~400	400~1000	1000~2000	2000~4000	Note		
	f	±0.05	±0.05	±0.1	±0.15	±0.2	±0.3	±0.5				
	m	±0.1	±0.1	±0.2	±0.3	±0.5	±0.8	±1.2	±2			
	c	±0.2	±0.3	±0.5	±0.8	±1.2	±2	±3	±4			
	v		±0.5	±1	±1.5	±2.5	±4	±6	±8			

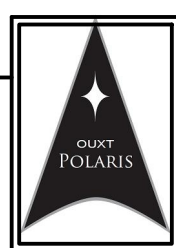

Worker T.sanada	Deadline 2013/12/27	Completion Date 2013/12/27	Qty. 8	Material アルミニウム 5052
Worker's Signature	Total Process Time [min./unit]	Designer's Signature	SheetSize A3	Designer T.sanada
			Pages 19 / 21	Date 2013/12/17
				Rev. 2
				Status リリース
				ProjectName / AssemblyName MaritimeRobotX2014 / RearProp
				PartName BottomArmFixingPlate1
				Drawing No. MRX14-RP-P016

Model Path = C:\Users\Tatsuya\GoogleDrive\OUXT\InventorProjects\MRX14\RearProp_2nd\BottomLinkArm2.ipt
 Drawing Path = C:\Users\Tatsuya\GoogleDrive\OUXT\InventorProjects\MRX14\RearProp_1st\Drawing\RearProp.idw

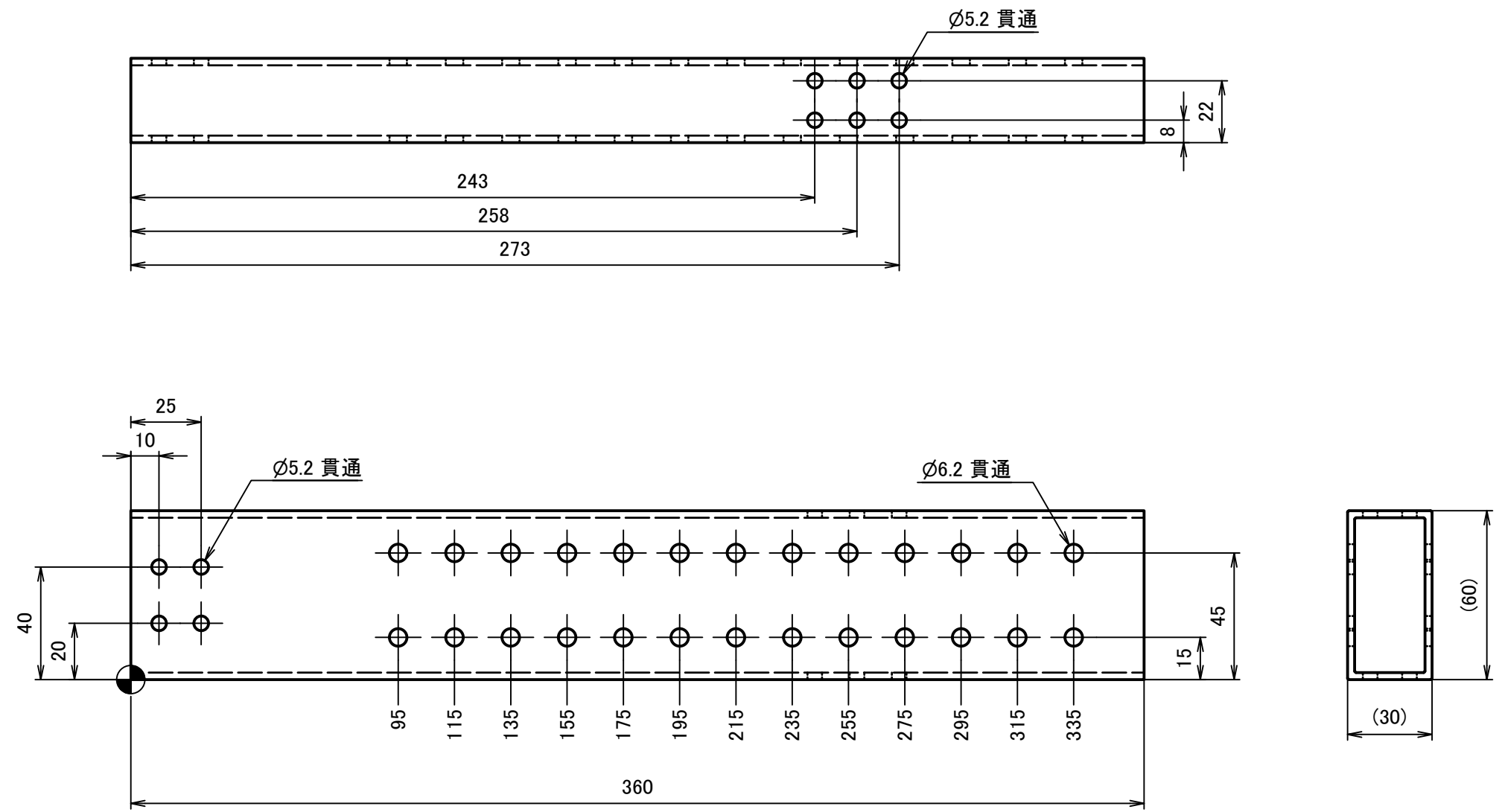

M = 401.116 g
 V = 148013.350 mm³
 SA = 121991.564 mm²

	(H)	(B)	(S)	(D)	(L)	(MM)	(MM)SPF550-VD (NCM)	(MC)	(TPP)	(LPM)	(3DP)	(3DP)DMM service
JIS B 0405	Division	0.5~3	3~6	6~30	30~120	120~400	400~1000	1000~2000	2000~4000	Note		
	f	±0.05	±0.05	±0.1	±0.15	±0.2	±0.3	±0.5				
	m	±0.1	±0.1	±0.2	±0.3	±0.5	±0.8	±1.2	±2			
	c	±0.2	±0.3	±0.5	±0.8	±1.2	±2	±3	±4			
	v		±0.5	±1	±1.5	±2.5	±4	±6	±8			

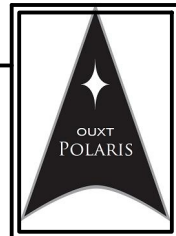

Worker
T.sanada
Worker's Signature

Deadline
2013/12/27
Total Process Time
[min./unit]

Completion Date
2013/12/27
Designer's Signature

Qty.
4
Sheet Size A3
Pages 20 / 21

Material	アルミニウム 6061		
Designer	T.sanada	Date	2013/12/25
Rev.	2	Status	リリース
ProjectName / AssemblyName	MaritimeRobotX2014 / RearProp		
PartName	BottomLinkArm2		
Drawing No.	MRX14-RP-P017		

Model Path = C:\Users\Tatsuya\GoogleDrive\OUXT\InventorProjects\MRX14\RearProp_1st\MotorClumpedPlate.ipt
 Drawing Path = C:\Users\Tatsuya\GoogleDrive\OUXT\InventorProjects\MRX14\RearProp_1st\Drawing\RearProp.idw

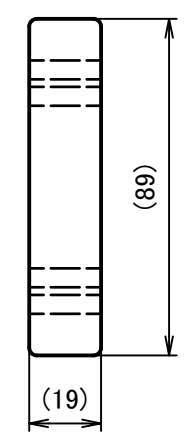
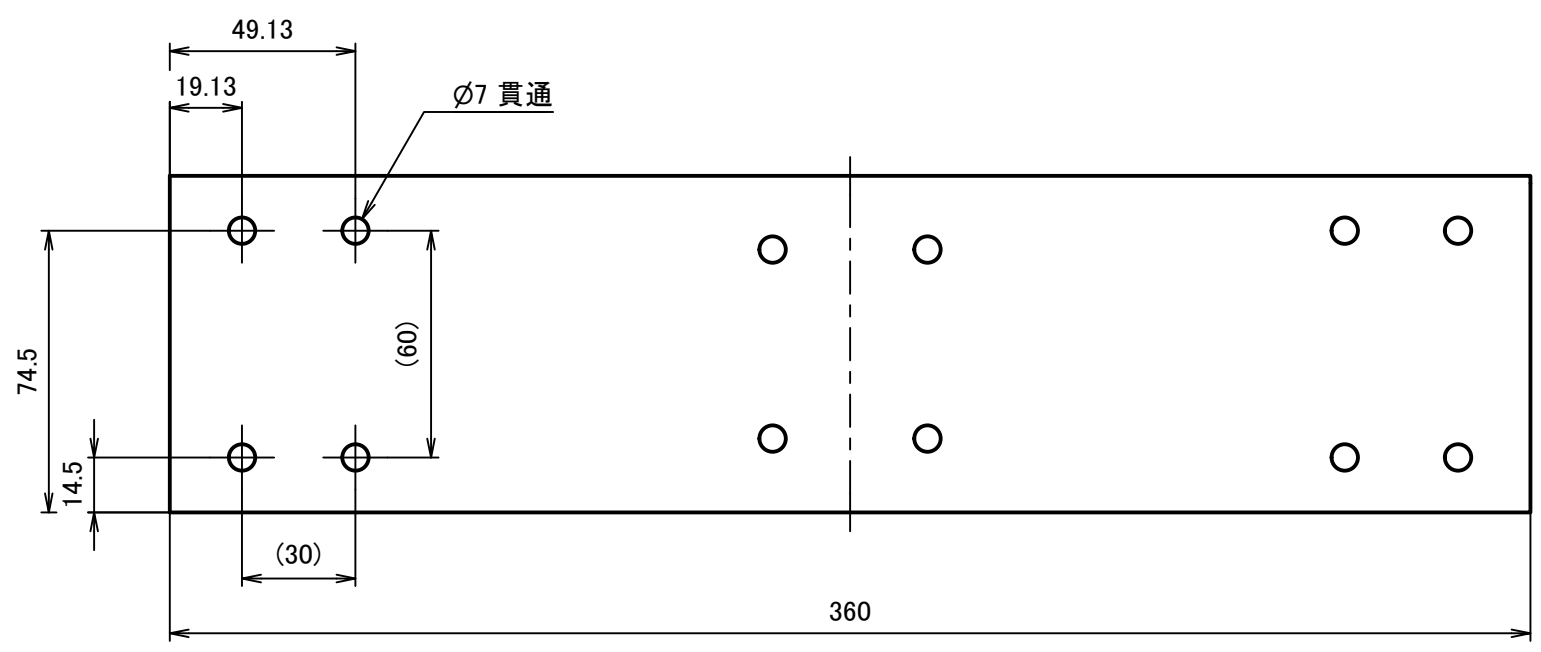

M = 431.698 g
 V = 598749.425 mm³
 SA = 83989.380 mm²

	(H)	(B)	(S)	(D)	(L)	(MM)	(MM)SPF550-VD (NCM)	(MC)	(TPP)	(LPM)	(3DP)	(3DP)DMM service
JIS B 0405	Division	0.5~3	3~6	6~30	30~120	120~400	400~1000	1000~2000	2000~4000	Note		
	f	±0.05	±0.05	±0.1	±0.15	±0.2	±0.3	±0.5				
	m	±0.1	±0.1	±0.2	±0.3	±0.5	±0.8	±1.2	±2			
	c	±0.2	±0.3	±0.5	±0.8	±1.2	±2	±3	±4			
	v		±0.5	±1	±1.5	±2.5	±4	±6	±8			

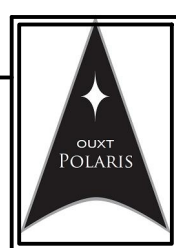

Worker T.sanada	Deadline 2013/12/27	Completion Date 2013/12/27	Qty. 2	Material オーク材、ホワイトオーク
Worker's Signature	Total Process Time [min./unit]	Designer's Signature	Designer T.sanada	Date 2013/12/26
			Rev. 2	Status リリース
			ProjectName / AssemblyName MaritimeRobotX2014 / RearProp	
			PartName MotorClumpedPlate	
			Drawing No. MRX14-RP-P018	
			SheetSize A3	
			Pages 21 / 21	